

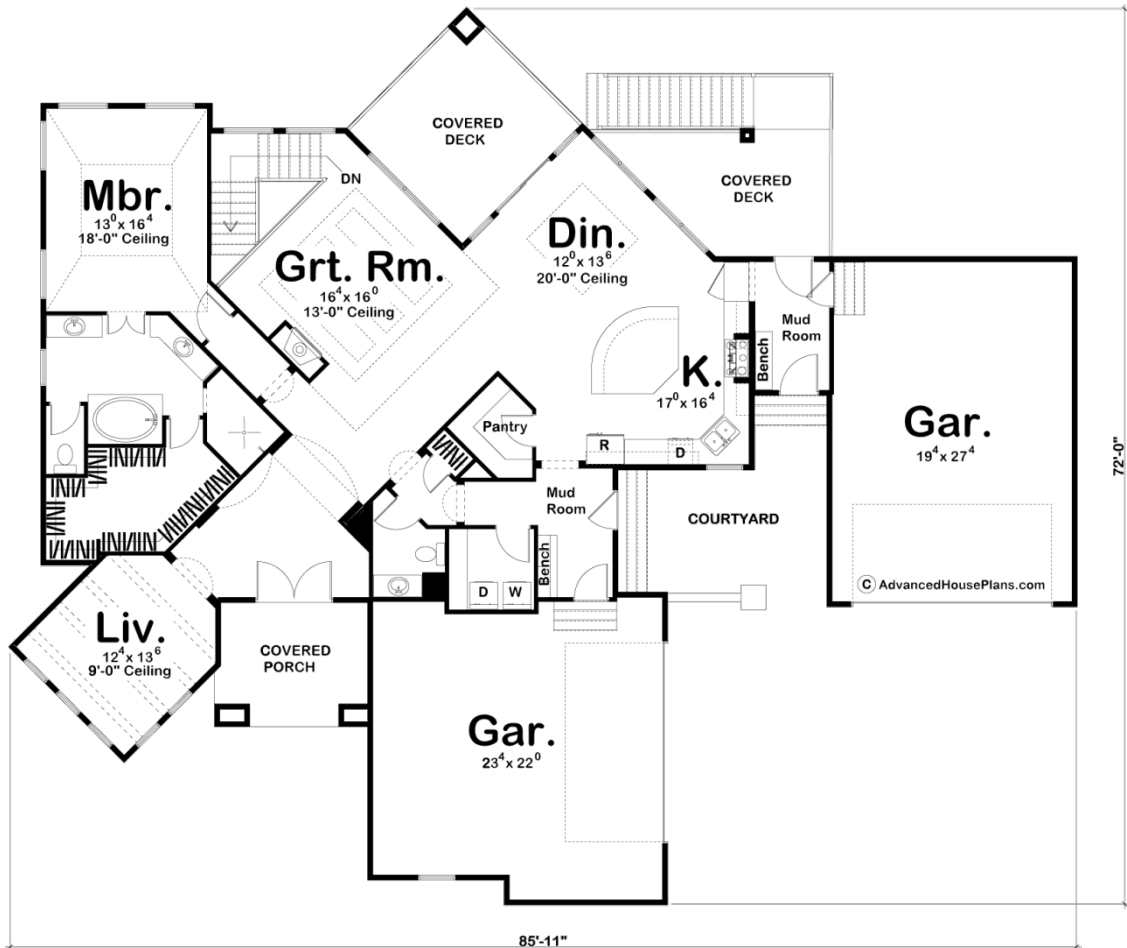

## 29119 - Hawthorne Data Sheet

2127 SQ FT	1 BEDS	2 BATHS	3 BAYS	86' 0" WIDE	72' 0" DEEP
---------------	-----------	------------	-----------	----------------	----------------



## Construction Specs

Layout

Bedrooms

Bathrooms	2
-----------	---

Garage Bays	3
-------------	---

### Square Footage

Main Level	2127 Sq. Ft.
------------	--------------

Garage	1120 Sq. Ft.
--------	--------------

Total Finished Area	2127 Sq. Ft.
---------------------	--------------

### Exterior Dimensions

Width	86' 0"
-------	--------

Depth	72' 0"
-------	--------

Ridge Height	25' 0"
--------------	--------

*Calculated from main floor line*

### Default Construction Stats

*Stats are unique to the individual plan.*

Foundation Type	Basement
-----------------	----------

Exterior Wall Construction	2x4
----------------------------	-----

Roof Pitches	6/12
--------------	------

Foundation Wall Height	9'
------------------------	----

Main Wall Height	10'
------------------	-----

## Plan Description

The Hawthorne is an impressive home, perfect for retiring couples. The plan is elegantly styled with the perfect blend of contemporary and rustic elements to create a charming modern mountain home. The home features open living spaces, with large windows for great views and daylighting. The Master Bedroom and Dining Room spaces have vaulted tower ceilings that give these spaces presence. The home is an entertainer's delight with 2 covered decks, allowing the party to flow outside. The oversized Master Suite features both a large whirlpool tub and custom walk-in tile shower. The walk-in closet is enormous.