

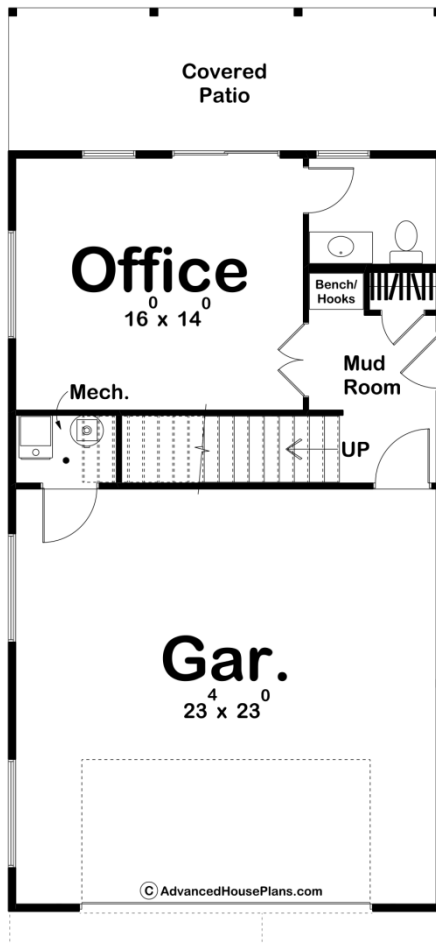

30272 - Goodwin Data Sheet

1422 SQ FT	2 BEDS	2 BATHS	2 BAYS	24' 0" WIDE	50' 0" DEEP
---------------	-----------	------------	-----------	----------------	----------------

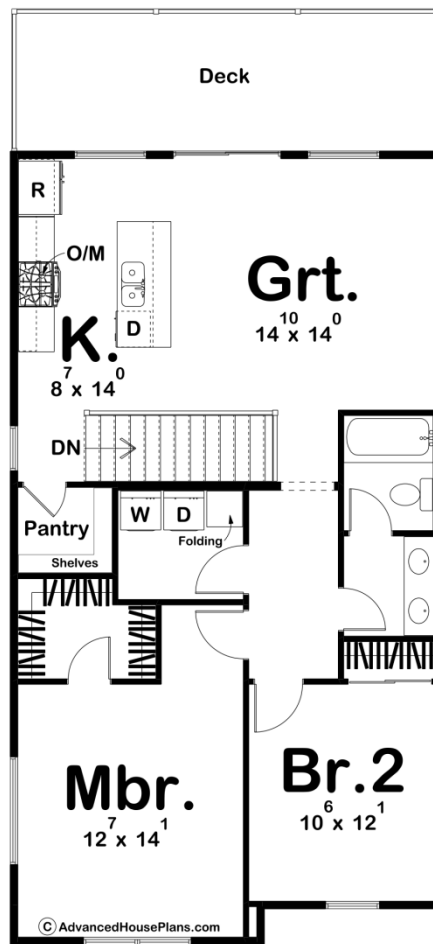



Construction Specs

Layout

Bedrooms	2
Bathrooms	2
Garage Bays	2

Square Footage

Main Level	425 Sq. Ft.
Second Level	997 Sq. Ft.
Garage	560 Sq. Ft.
Total Finished Area	1422 Sq. Ft.

Exterior Dimensions

Width	24' 0"
Depth	50' 0"
Ridge Height	25' 0"
<i>Calculated from main floor line</i>	

Default Construction Stats

Stats are unique to the individual plan.

Foundation Type	Slab
Exterior Wall Construction	2x4
Roof Pitches	Primary 4/12, Secondary 3/12
Main Wall Height	10'
Second Wall Height	8'

Plan Description

The Goodwin plan is a modern style carriage house that boasts 1422 square feet, 2 beds and 2 baths. The exterior of this home is unique with mixtures of board and batten siding, stone, and vinyl siding. The glass garage and color combination gives this plan a modern feel, while also providing hints of a modern farmhouse. Heading in through the two car garage welcomes you to a mudroom as well as an office and powder bath. This area is perfect for those who work from home and want a space away from their living quarters while not having to travel. Head upstairs to find the additional living space, including the great room, kitchen, a bathroom, and two bedrooms. A walk-in pantry and laundry room can also be found here, as well as a beautiful island in the kitchen and a walk-in closet in the master bedroom.