

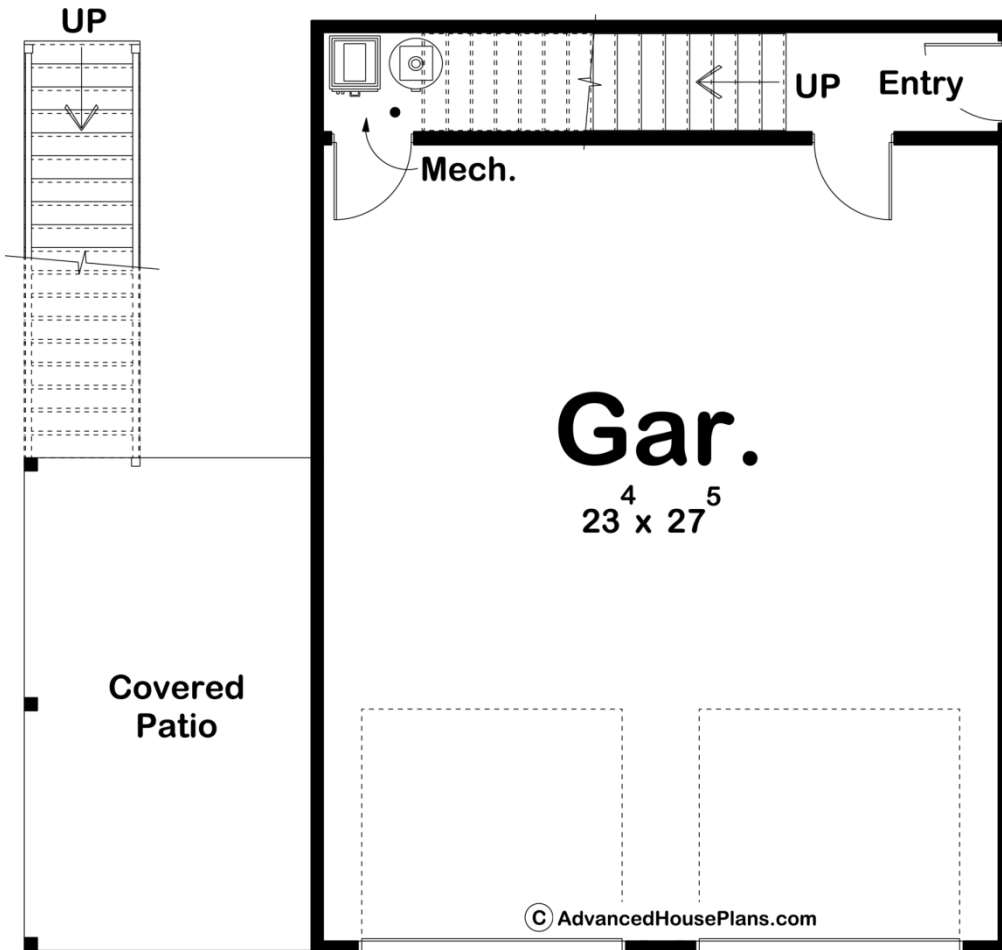

29916 - Gideon Data Sheet

839 SQ FT	1 BEDS	1 BATHS	2 BAYS	34' 0" WIDE	32' 0" DEEP
--------------	-----------	------------	-----------	----------------	----------------

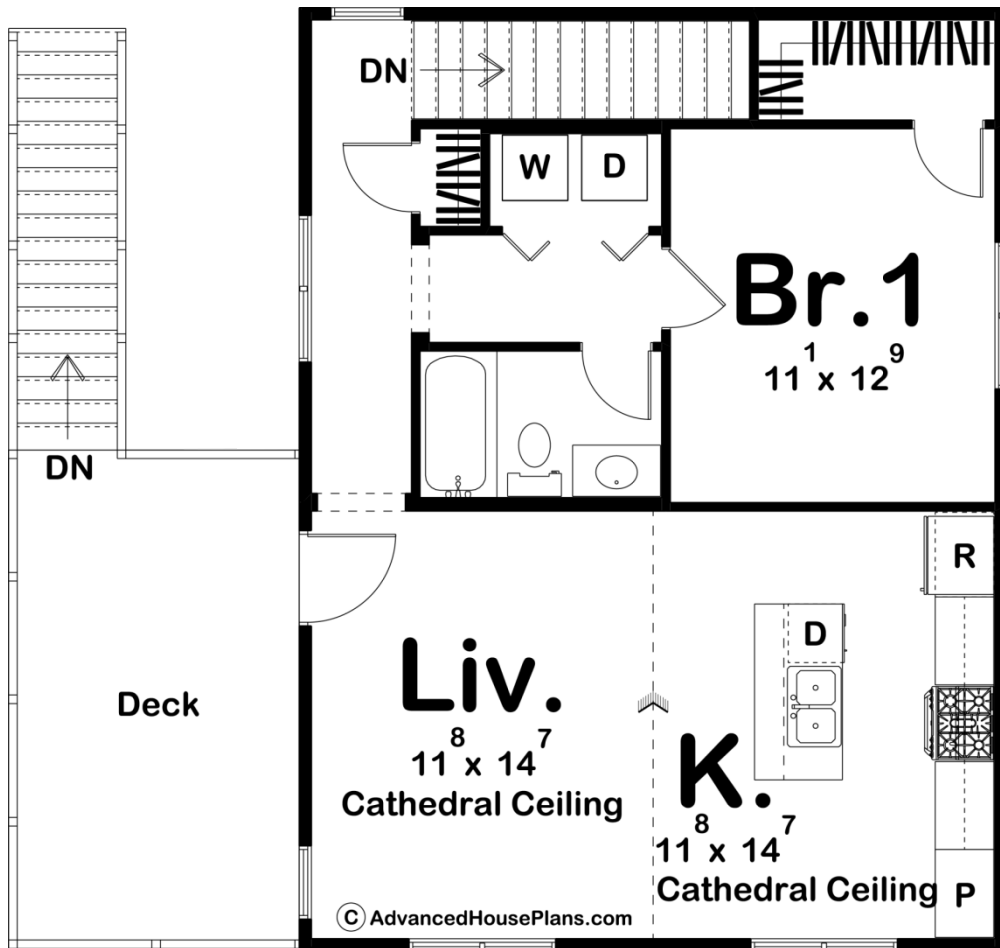



Construction Specs

Layout

Bedrooms	1
Bathrooms	1
Garage Bays	2

Square Footage

Main Level	103 Sq. Ft.
Second Level	736 Sq. Ft.
Garage	667 Sq. Ft.
Total Finished Area	839 Sq. Ft.

Exterior Dimensions

Width	34' 0"
Depth	32' 0"

Default Construction Stats

Stats are unique to the individual plan.

Foundation Type	Slab
-----------------	------

Exterior Wall Construction	2x4
Roof Pitches	6/12 Primary
Main Wall Height	9'
Second Wall Height	9'

Plan Description

The Gideon plan is a wonderful carriage house plan that features a 1 bedroom apartment above a 2 car garage. A covered patio on the main floor creates a perfect space to relax after working in your garage. Upstairs, a well thought out apartment includes a bedroom with a walk-in closet. The kitchen opens up to the living room and includes a pantry and an island.