

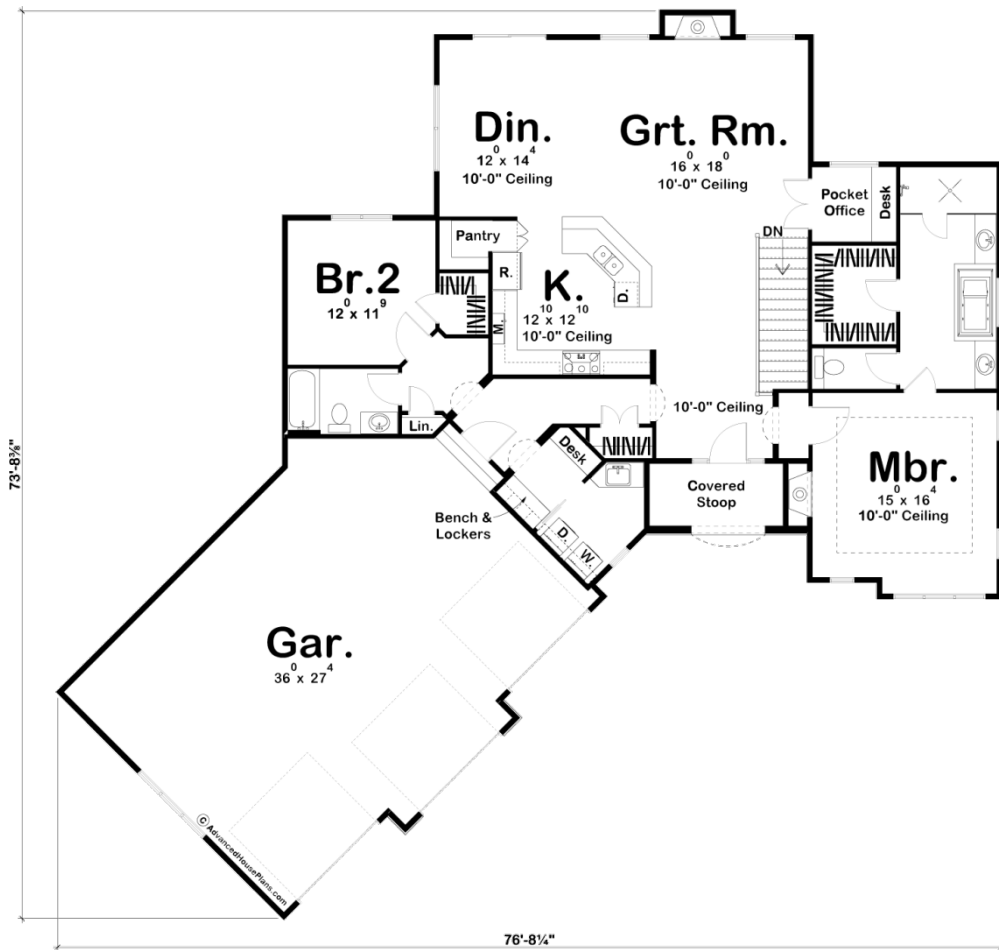

29384 - Foxborough Data Sheet

1904 SQ FT	2 BEDS	2 BATHS	3 BAYS	77' 0" WIDE	74' 0" DEEP
---------------	-----------	------------	-----------	----------------	----------------



Construction Specs

Layout

Bedrooms

Bathrooms	2
-----------	---

Garage Bays	3
-------------	---

Square Footage

Main Level	1904 Sq. Ft.
------------	--------------

Garage	958 Sq. Ft.
--------	-------------

Total Finished Area	1904 Sq. Ft.
---------------------	--------------

Exterior Dimensions

Width	77' 0"
-------	--------

Depth	74' 0"
-------	--------

Ridge Height	24' 0"
--------------	--------

Calculated from main floor line

Default Construction Stats

Stats are unique to the individual plan.

Foundation Type	Basement
-----------------	----------

Exterior Wall Construction	2x4
----------------------------	-----

Roof Pitches	8/12 front-back 12/12 sides
--------------	-----------------------------

Foundation Wall Height	9'
------------------------	----

Main Wall Height	9'
------------------	----

Plan Description

With a gorgeous cottage-style front elevation, and a spacious, open floor plan, the Foxborough sets itself apart. We've blended stucco, stone, and wood, to create an almost magical appeal. The look is complemented with decorative wood brackets, tudor-style trim, steep roof pitches, and a prominent stone fireplace that brings it all together. This house plan features a very open floor plan, massive 3 car garage, and a kitchen that is just as suited for entertaining as it is for cooking. The Master Suite has 10' ceiling, and a large bathroom with an oversized tub and walk-in tile shower.