

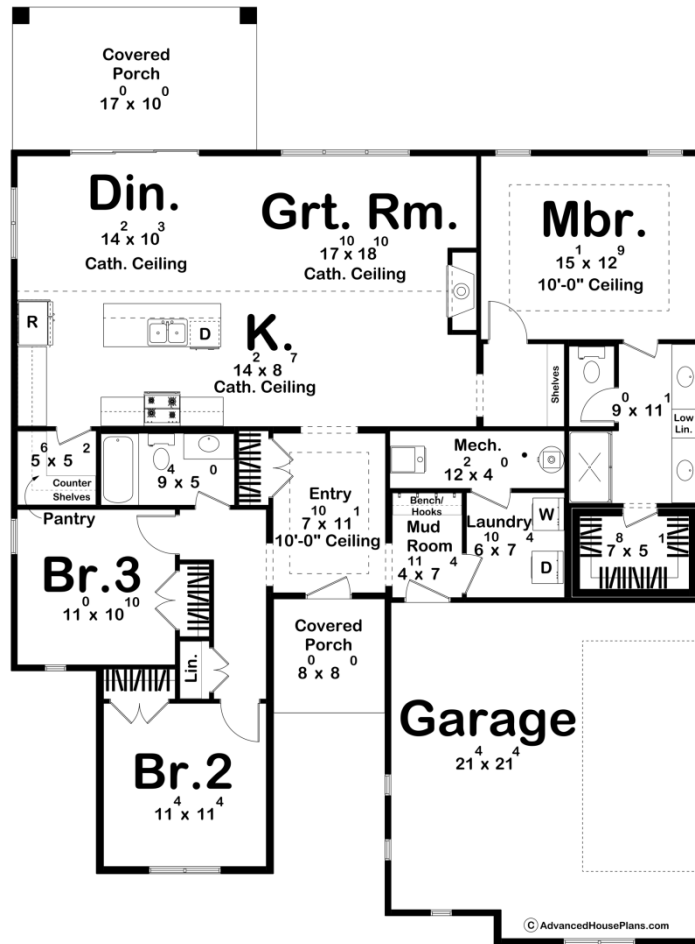

**30539 - Finley Park Data Sheet**

1686 SQ FT	3 BEDS	2 BATHS	2 BAYS	48' 0" WIDE	65' 0" DEEP
---------------	-----------	------------	-----------	----------------	----------------



**Construction Specs**

**Layout**

Bedrooms

Bathrooms	2
Garage Bays	2

### Square Footage

Main Level	1686 Sq. Ft.
Covered Area	233 Sq. Ft.
Garage	513 Sq. Ft.
Total Finished Area	1686 Sq. Ft.

### Exterior Dimensions

Width	48' 0"
Depth	65' 0"
Ridge Height <i>Calculated from main floor line</i>	25' 6"

### Default Construction Stats

*Stats are unique to the individual plan.*

Foundation Type	Slab
Exterior Wall Construction	2x4
Roof Pitches	Primary 12/12, Secondary 14/12, 4/12, 6/12
Main Wall Height	9'

## Plan Description

Introducing the Finley Park, a stunning modern cottage-style home with a beautiful brick and stucco facade. This three-bedroom, two-bathroom residence offers an open floor plan featuring a great room, dining room, and kitchen, all under a soaring cathedral ceiling. The master bedroom includes a unique walk-in closet that doubles as a storm shelter, ensuring safety and convenience. Additional features include a two-car garage, a covered porch for outdoor enjoyment, and a practical mudroom. A designated laundry room adds to the home's functionality. Experience the perfect blend of modern design and cottage charm with Finley Park.