

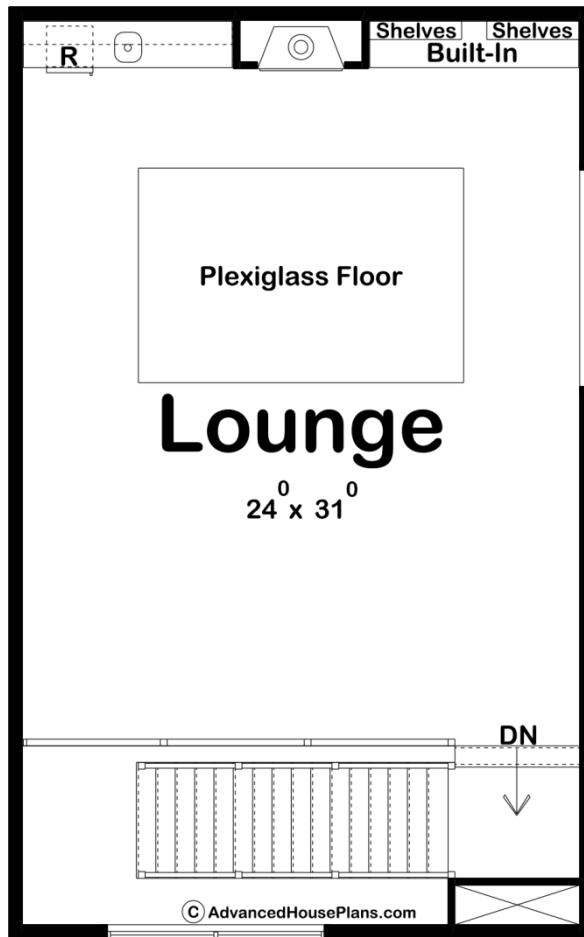

### 30228 - Falls Canyon Data Sheet

835 SQ FT	0 BEDS	1 BATHS	7 BAYS	90' 0" WIDE	40' 0" DEEP
--------------	-----------	------------	-----------	----------------	----------------





## Construction Specs

### Layout

Bathrooms	1
Garage Bays	7

### Square Footage

Second Level	795 Sq. Ft.
Basement Level	40 Sq. Ft.
Garage	2946 Sq. Ft.
Total Finished Area	835 Sq. Ft.

### Exterior Dimensions

Width	90' 0"
Depth	40' 0"

### Default Construction Stats

*Stats are unique to the individual plan.*

Foundation Type	Slab
Exterior Wall Construction	2x6

Roof Pitches	2/12 Primary
Main Wall Height	10'
Second Wall Height	10'

## Plan Description

The Falls Canyon is a stunning 7-car garage with a shop and lounge area. It is every car-lovers dream. The modern details scream luxury from the outside to the inside. Inside is space to show off many of your favorite cars. There is a shop area to store all of your tools as well. The main floor includes a bath, a mechanical room, and a storage room. Heading upstairs is a large lounge area equipped with a fireplace and a plexiglass floor so you can look down and see your vehicle in the 7th bay.