

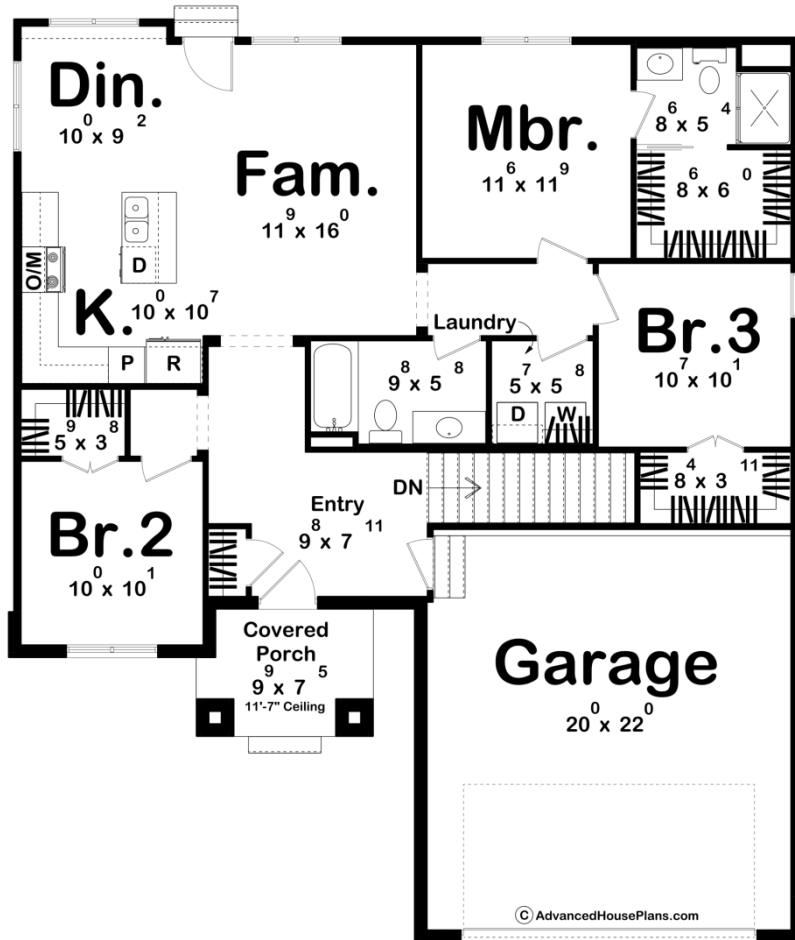

29708 - Elk Park Data Sheet

| | | | | | |
|---------------|-----------|------------|-----------|----------------|----------------|
| 1290 SQ FT | 3 BEDS | 2 BATHS | 2 BAYS | 43' 0" WIDE | 50' 4" DEEP |
|---------------|-----------|------------|-----------|----------------|----------------|



Construction Specs

Layout

Bedrooms

| | |
|---|--------------|
| Bathrooms | 2 |
| Garage Bays | 2 |
| Square Footage | |
| Main Level | 1290 Sq. Ft. |
| Garage | 459 Sq. Ft. |
| Total Finished Area | 1290 Sq. Ft. |
| Exterior Dimensions | |
| Width | 43' 0" |
| Depth | 50' 4" |
| Default Construction Stats | |
| <i>Stats are unique to the individual plan.</i> | |
| Foundation Type | Basement |
| Exterior Wall Construction | 2x4 |
| Roof Pitches | 4/12 Primary |
| Foundation Wall Height | 9' |
| Main Wall Height | 9' |

Plan Description

Welcome to Elk Park—a perfect blend of modern style and cozy living! This 1,290 sq. ft. one-story home greets you with a covered porch featuring brick columns and warm wood accents. Inside, an oversized entry sets the tone for a home that feels anything but small. The kitchen shines with generous counter space, a functional island with a breakfast bar, and a walk-up pantry. The private master suite offers a relaxing retreat with its own walk-in closet and bath. Bedrooms 2 and 3 each include walk-in closets, giving everyone their own organized space. Elk Park is proof that great design comes in every size!