

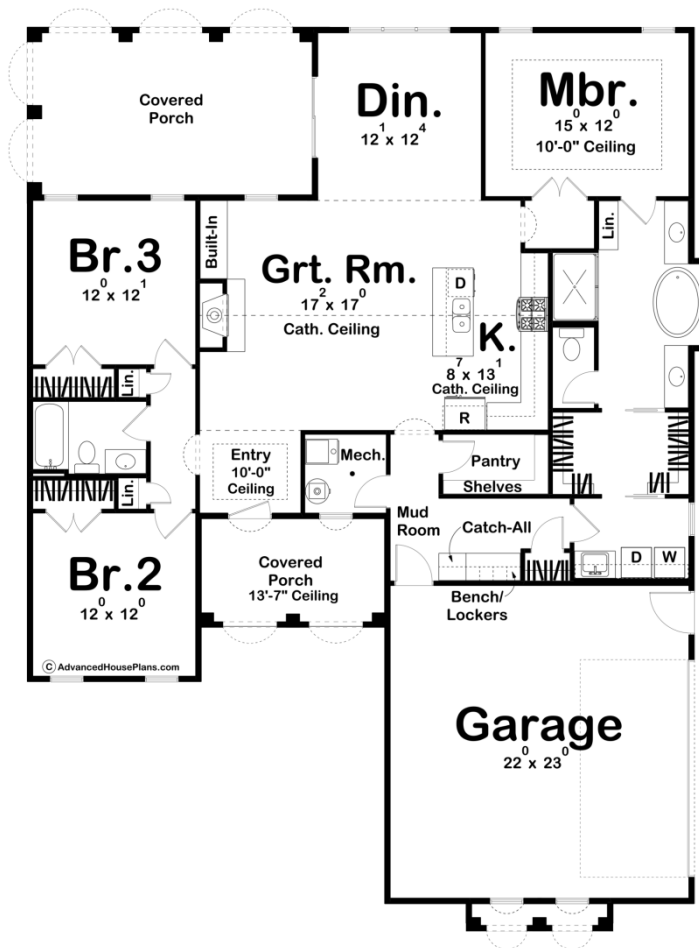

**30276 - Eden Park Data Sheet**

1742 SQ FT	3 BEDS	2 BATHS	2 BAYS	50' 0" WIDE	66' 4" DEEP
---------------	-----------	------------	-----------	----------------	----------------



**Construction Specs**

Layout

Bedrooms

Bathrooms	2
-----------	---

Garage Bays	2
-------------	---

### Square Footage

Main Level	1742 Sq. Ft.
------------	--------------

Covered Area	368 Sq. Ft.
--------------	-------------

Garage	529 Sq. Ft.
--------	-------------

Total Finished Area	1742 Sq. Ft.
---------------------	--------------

### Exterior Dimensions

Width	50' 0"
-------	--------

Depth	66' 4"
-------	--------

### Default Construction Stats

*Stats are unique to the individual plan.*

Foundation Type	Slab
-----------------	------

Exterior Wall Construction	2x4
----------------------------	-----

Roof Pitches	6/12 Primary
--------------	--------------

Main Wall Height	9'
------------------	----

## Plan Description

The Eden Park is a Mediterranean Style Ranch with a functional floor plan and unique exterior. The stucco finish and large pillars give this home great curb appeal. The Eden Park features an open floor plan that feels huge! After passing the entry, you are greeted by tall cathedral ceilings throughout the great room and kitchen. There is a deep walk-in pantry, a mudroom that connects to the laundry room, which then flows right into the master bedroom walk-in closet. In the master bathroom there are his and her vanities along with a soaker tub. On the other side of the house are two bedrooms that share a hall bathroom. The side load garage offers ample of space for most vehicles.