

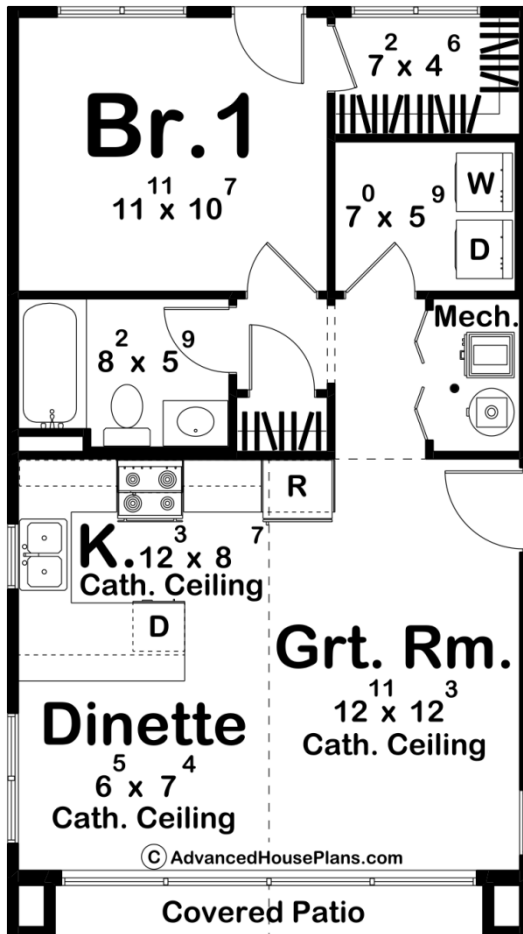

30546 - Durango Data Sheet

654 SQ FT	1 BEDS	1 BATHS	0 BAYS	20' 0" WIDE	35' 8" DEEP
--------------	-----------	------------	-----------	----------------	----------------



Construction Specs

Layout

Bedrooms

Square Footage

Main Level	654 Sq. Ft.
Total Finished Area	654 Sq. Ft.

Exterior Dimensions

Width	20' 0"
Depth	35' 8"

Default Construction Stats

Stats are unique to the individual plan.

Foundation Type	Slab
Exterior Wall Construction	2x4
Roof Pitches	Primary 12/12
Main Wall Height	9'

Plan Description

Imagine transforming your backyard or property with the Durango, a modern ADU house plan featuring one bedroom, one bathroom, and an open concept main area. This isn't just an addition to your property; it's a versatile, stylish, and highly functional space that offers endless possibilities. The beauty of this ADU lies in its design efficiency and aesthetic appeal. The open concept main area creates a seamless flow between the living, dining, and kitchen spaces, making it perfect for entertaining or simply enjoying a spacious, airy living environment. The cathedral ceiling adds a touch of elegance and grandeur, enhancing the sense of space and filling the home with natural light. Whether you're looking to accommodate guests, generate rental income, or create a private retreat, this ADU is the ideal solution. The single bedroom and bathroom layout is perfect for individuals or couples, offering a cozy living space that is easy to maintain. Investing in this modern ADU house plan means adding significant value to your property while enjoying the benefits of a beautifully designed, functional space. Don't miss out on the opportunity to enhance your living experience and elevate your property with this exceptional ADU design.