

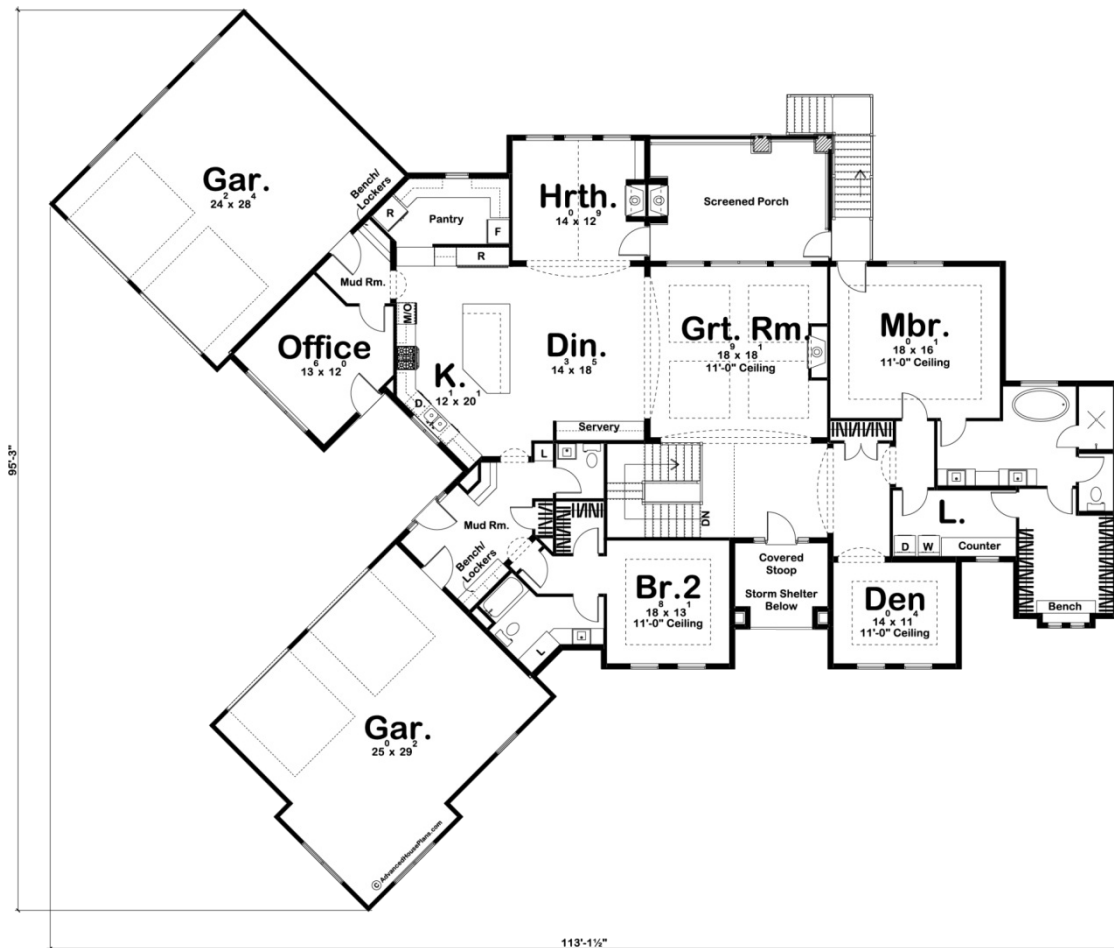

29501 - Dedlow Data Sheet

3285 SQ FT	2 BEDS	3 BATHS	4 BAYS	114' 0" WIDE	96' 0" DEEP
---------------	-----------	------------	-----------	-----------------	----------------



Construction Specs

Layout

Bedrooms

Bathrooms	3
-----------	---

Garage Bays	4
-------------	---

Square Footage

Main Level	3285 Sq. Ft.
------------	--------------

Garage	1441 Sq. Ft.
--------	--------------

Total Finished Area	3285 Sq. Ft.
---------------------	--------------

Exterior Dimensions

Width	114' 0"
-------	---------

Depth	96' 0"
-------	--------

Ridge Height	23' 0"
--------------	--------

Calculated from main floor line

Default Construction Stats

Stats are unique to the individual plan.

Foundation Type	Basement
-----------------	----------

Exterior Wall Construction	2x6
----------------------------	-----

Roof Pitches	6/12
--------------	------

Foundation Wall Height	10'
------------------------	-----

Main Wall Height	10'
------------------	-----

Plan Description

Classic Mediterranean detailing could easily place this beautiful 1-story house plan in the rolling hills of Tuscany. A sense of grandeur captivates guest with an entry that offers views through arched openings into a large great room that is warmed by a fireplace and brightened by a trio of windows that look out into a fireplace warmed screened porch. Adjacent to the great room is a large dining area that flows into an open kitchen. The kitchen features ample counter space, an island workspace/breakfast bar, and a walk-in pantry. Just steps away from the kitchen lies a hearth room that is perfect for entertaining. The master suite lies only steps away from a stately den. The bedroom accesses the rear screened porch and enjoys sunny views to the rear. The master suite opens to a pampering bath area that includes an elegant oval soaking tub, walk-in shower, compartmented toilet and sizeable walk-in closet with dressing bench. The walk in closet has a convenient door leading to the laundry area.