

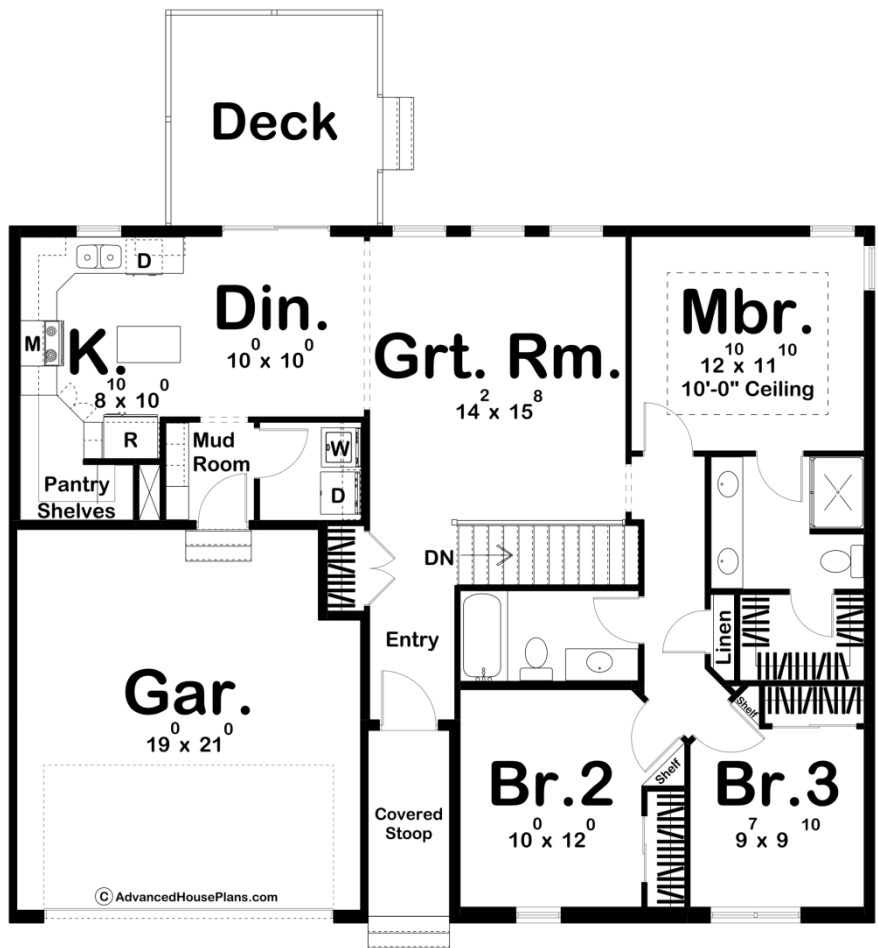

30106 - Crofton Data Sheet

1353 SQ FT	3 BEDS	2 BATHS	2 BAYS	47' 8" WIDE	50' 0" DEEP
---------------	-----------	------------	-----------	----------------	----------------



Construction Specs

Layout

Bedrooms

Bathrooms	2
-----------	---

Garage Bays	2
-------------	---

Square Footage

Main Level	1353 Sq. Ft.
------------	--------------

Garage	405 Sq. Ft.
--------	-------------

Total Finished Area	1353 Sq. Ft.
---------------------	--------------

Exterior Dimensions

Width	47' 8"
-------	--------

Depth	50' 0"
-------	--------

Default Construction Stats

Stats are unique to the individual plan.

Foundation Type	Basement
-----------------	----------

Exterior Wall Construction	2x4
----------------------------	-----

Roof Pitches	8/12 Primary
--------------	--------------

Foundation Wall Height	9'
------------------------	----

Main Wall Height	9'
------------------	----

Plan Description

The Crofton plan makes great use of its small space to create a fantastic simple house. As you walk through the entryway you will see a large great room with a window to the rear of the home. The dining room flows into a beautiful kitchen with an island and a walk in pantry. On the right side of the home you will find a wonderful master suite complete with his/her vanities, a walk in shower and a walk in closet. Bedrooms 2 and 3 share a centrally located hall bathroom. The house is also accessible from the 2 car garage through a simple and practical mudroom with lockers. This house is sure to impress at its small 1353 sq. ft. footprint.