

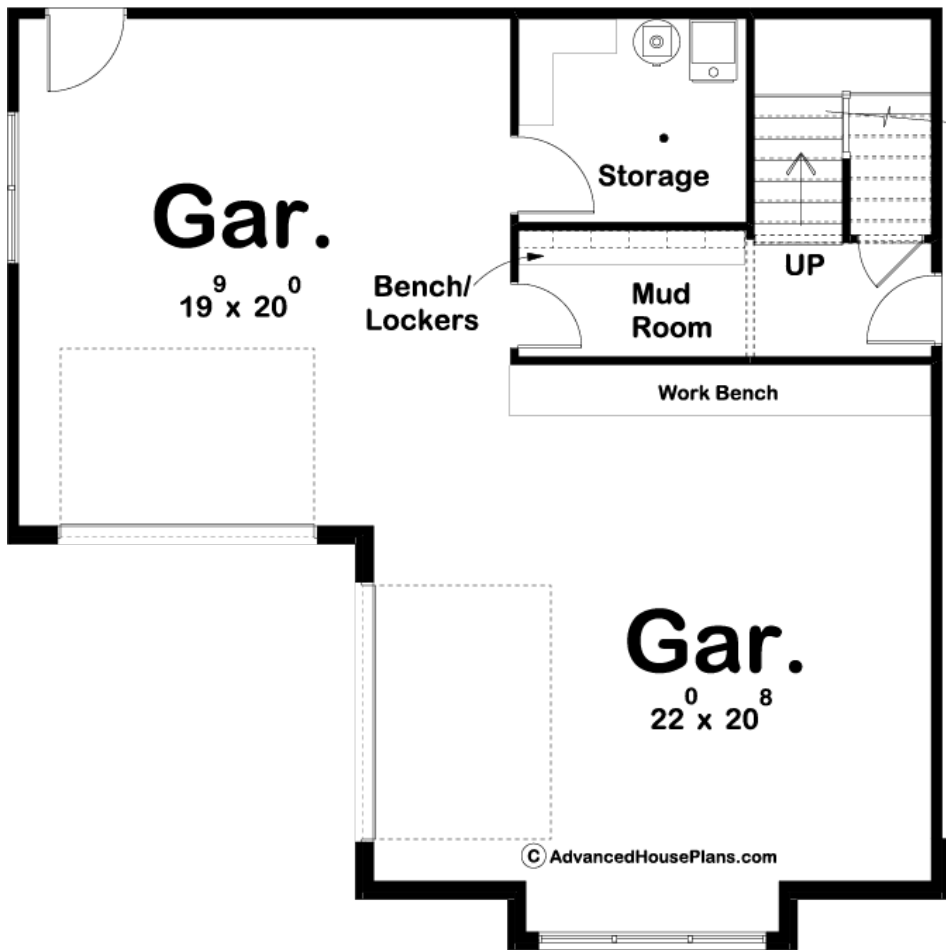

29737 - Copper Creek Data Sheet

1077 SQ FT	1 BEDS	1 BATHS	2 BAYS	37' 0" WIDE	37' 0" DEEP
---------------	-----------	------------	-----------	----------------	----------------

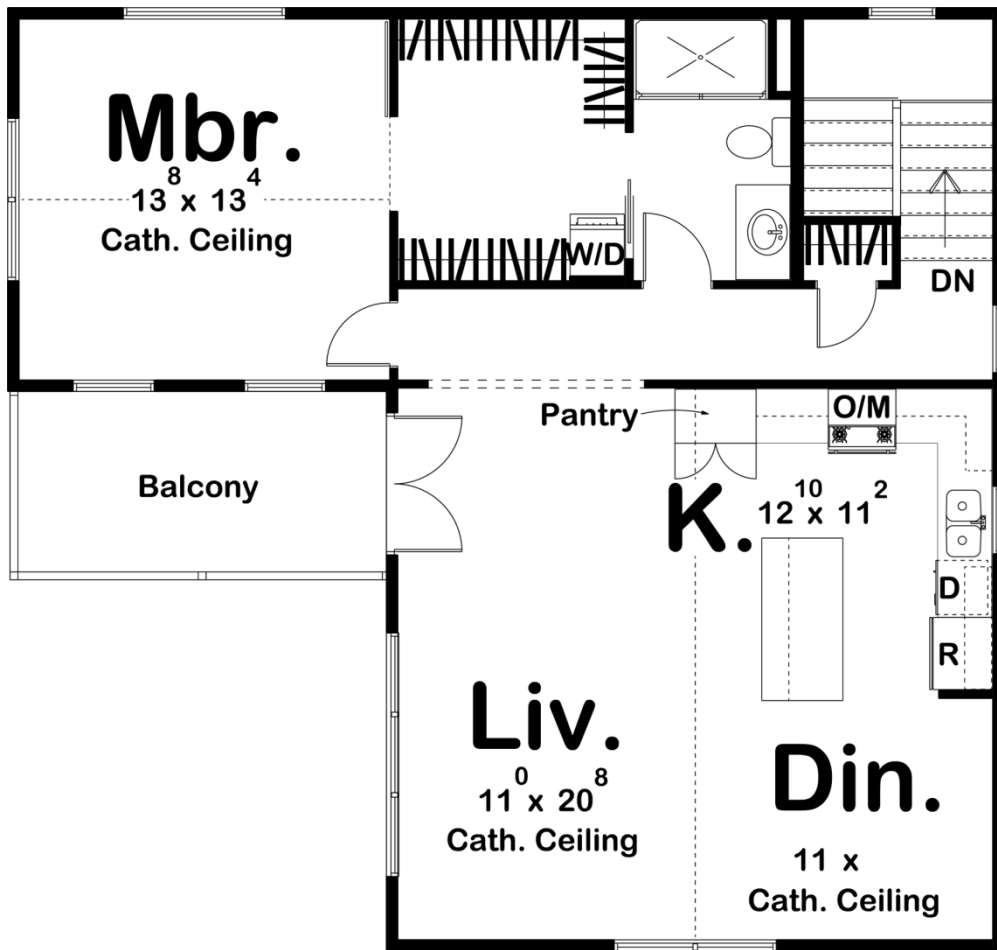



Construction Specs

Layout

Bedrooms	1
Bathrooms	1
Garage Bays	2

Square Footage

Main Level	153 Sq. Ft.
Second Level	924 Sq. Ft.
Garage	852 Sq. Ft.
Total Finished Area	1077 Sq. Ft.

Exterior Dimensions

Width	37' 0"
Depth	37' 0"

Default Construction Stats

Stats are unique to the individual plan.

Foundation Type	Slab
-----------------	------

Exterior Wall Construction	2x4
Roof Pitches	8/12 Primary, 6/12 Secondary
Main Wall Height	9'
Second Wall Height	9'

Plan Description

The courtyard split garage gives the Copper Creek the appearance of a home but the functionality of an apartment garage. On the outside, a beautiful blend of siding, brick, wood, and metal roofing gives this plan great curb appeal. On the main level, there is ample work space with a built-in workbench. There is also a useful storage closet with built-in shelves and a mudroom that includes a bench/lockers. Upstairs, you will find a functional 1 bedroom apartment. The family room, kitchen, and dining room lie under a soaring cathedral ceiling to make the living area feel open. The kitchen includes a large kitchen island with a snack bar and a pantry. Just off the family room is a beautiful balcony that is accessed through french doors. The master suite includes a large walk-through closet that has its own access to the apartment's bathroom.