

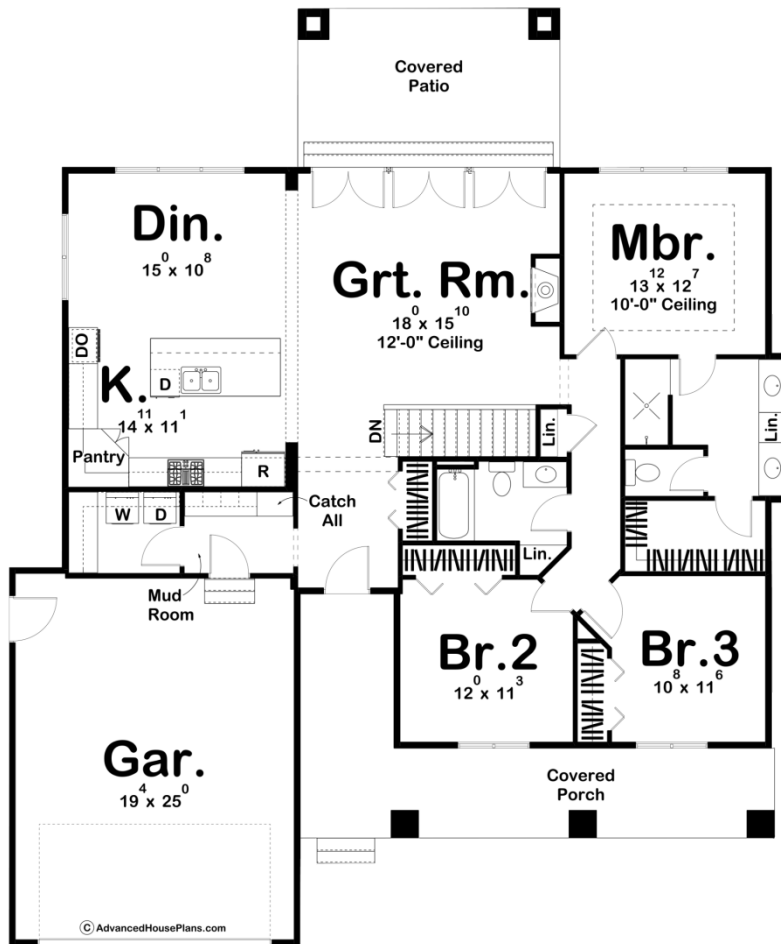

**29532 - Clemons Data Sheet**

1712 SQ FT	3 BEDS	2 BATHS	2 BAYS	54' 0" WIDE	64' 8" DEEP
---------------	-----------	------------	-----------	----------------	----------------



**Construction Specs**

Layout

Bedrooms

Bathrooms	2
Garage Bays	2

### Square Footage

Main Level	1712 Sq. Ft.
Covered Area	479 Sq. Ft.
Garage	509 Sq. Ft.
Total Finished Area	1712 Sq. Ft.

### Exterior Dimensions

Width	54' 0"
Depth	64' 8"
Ridge Height <i>Calculated from main floor line</i>	23' 0"

### Default Construction Stats

*Stats are unique to the individual plan.*

Foundation Type	Basement
Exterior Wall Construction	2x4
Roof Pitches	Primary 8/12, Secondary 10/12, 4/12
Foundation Wall Height	9'
Main Wall Height	9'

## Plan Description

The Clemons plan is a beautiful Modern Farmhouse style ranch plan. The exterior of the home features board and batten siding, brick, and wood accents. A front-covered porch greets guests into the home. Inside the home, the great room, dining room, and kitchen are arranged in an open layout. The great room is warmed by a fireplace and has 3 sets of french doors that open the room up to the rear covered patio. The kitchen includes a large island and a walk-in pantry. The bedrooms can all be found on the right side of the home. The master bedroom lies under a decorative trayed ceiling. The master bathroom has his/her vanities and a walk-in shower. Bedrooms 2 and 3 share a centrally located hall bathroom with the main living space. The homes 2-car garage accesses the home through a convenient mudroom with a bench, lockers, and a catch-all.