

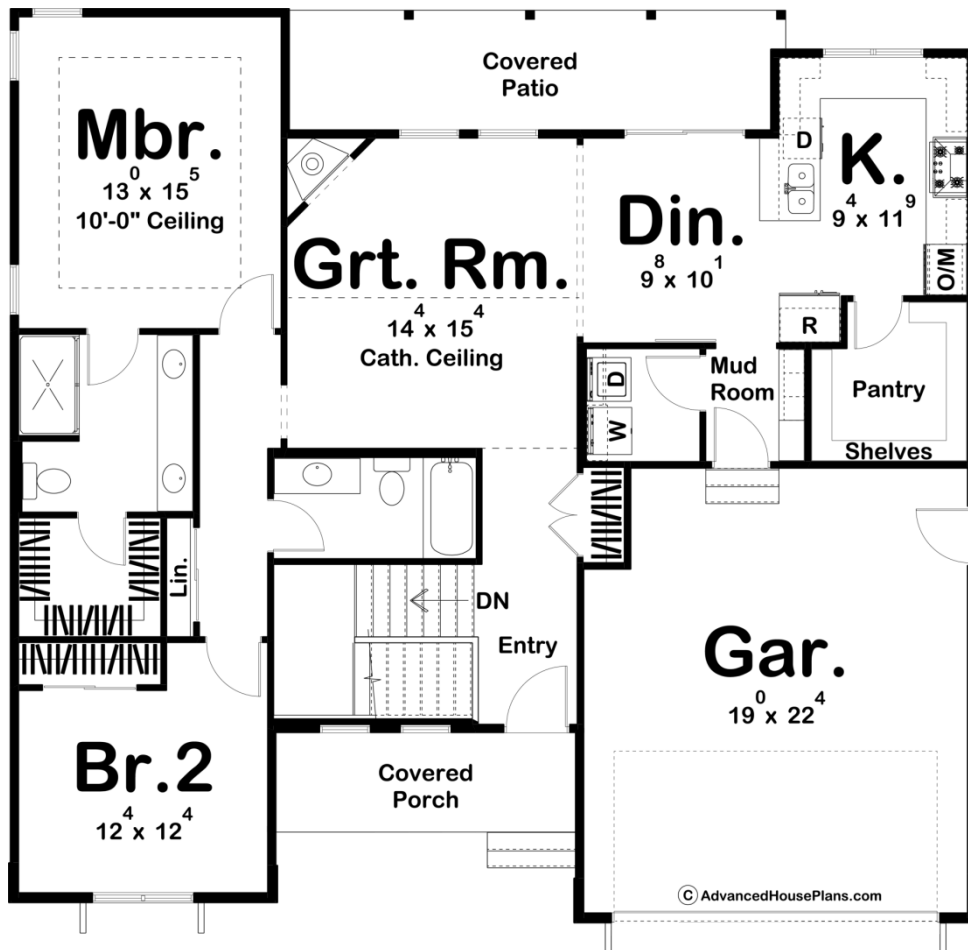

29898 - Cameron Data Sheet

1403 SQ FT	2 BEDS	2 BATHS	2 BAYS	48' 0" WIDE	45' 0" DEEP
---------------	-----------	------------	-----------	----------------	----------------



Construction Specs

Layout

Bedrooms

Bathrooms	2
Garage Bays	2

Square Footage

Main Level	1403 Sq. Ft.
Covered Area	219 Sq. Ft.
Garage	423 Sq. Ft.
Total Finished Area	1403 Sq. Ft.

Exterior Dimensions

Width	48' 0"
Depth	45' 0"

Default Construction Stats

Stats are unique to the individual plan.

Foundation Type	Basement
Exterior Wall Construction	2x4
Roof Pitches	6/12 Primary, 8/12 3/12 Secondary
Foundation Wall Height	9'
Main Wall Height	9'

Plan Description

Cameron is a beautiful and affordable 1 story house plan. The exterior is highlighted by board and batten siding and a shed dormer to give it that modern farmhouse look. At just over 1400 sq ft, this house packs a lot of features into an efficient footprint. As you enter the home, you'll find yourself in a magnificent great room that lies under a soaring cathedral ceiling and is warmed by a cozy corner fireplace. The dining room and kitchen flow nicely in an open layout. The kitchen includes a large walk-in pantry. Tucked behind the great room, you'll find the wonderful master suite. The master bedroom lies under a decorative trayed ceiling and includes his/her vanities and a large walk-in closet. Bedroom 2 shares a bathroom with the main living space of the home. The home's 2 car garage accesses the home through a convenient mudroom with a bench and lockers.