

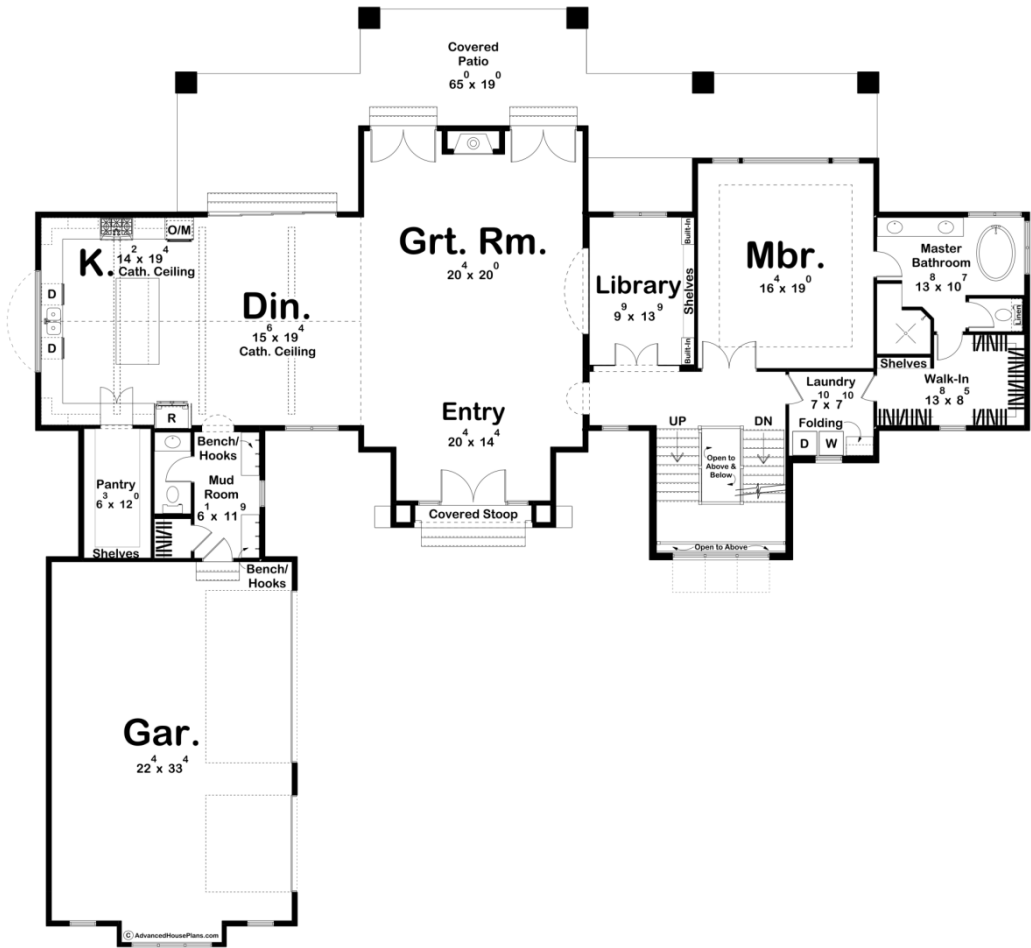

30289 - Camelback Ranch Data Sheet

4001 SQ FT	4 BEDS	4 BATHS	3 BAYS	92' 0" WIDE	87' 0" DEEP
---------------	-----------	------------	-----------	----------------	----------------

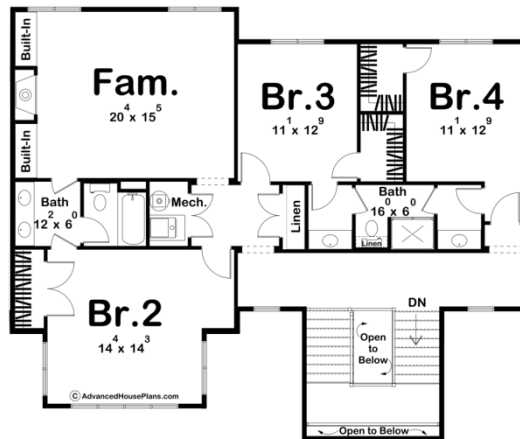



Construction Specs

Layout

Bedrooms	4
Bathrooms	4
Garage Bays	3

Square Footage

Main Level	2600 Sq. Ft.
Second Level	1401 Sq. Ft.
Covered Area	740 Sq. Ft.
Garage	796 Sq. Ft.
Total Finished Area	4001 Sq. Ft.

Exterior Dimensions

Width	92' 0"
Depth	87' 0"

Default Construction Stats

Stats are unique to the individual plan.

Foundation Type	Basement
Exterior Wall Construction	2x4
Roof Pitches	Primary 10/12, Secondary 4/12
Foundation Wall Height	9'
Main Wall Height	10'
Second Wall Height	9'

Plan Description

The Camelback Ranch is a beautifully designed French Country home. The stone exterior combined with the steeper pitches, gives this rustic home such a cozy feel. On the inside, you are greeted by a large entry flowing into the great room. The great room has a built-in fireplace and access to the rear covered patio. To the left is the dining/kitchen space. This area is enlarged with the tall cathedral ceilings and exposed beams. The dining room has access to the rear covered patio while the kitchen is equipped with a large island and a beautiful arched window looking out from over the sink. There is a walk-in hidden pantry along with dual dishwashers. The mudroom is located off the courtyard garage equipped with a half bath and bench and hooks. The right wing of the home houses a library and the master suite. The master bedroom has its own bath with a soaking tub and walk-in shower. The bathroom flows right into the walk-in closet that then flows into the laundry room. Upstairs are 3 additional bedrooms and two baths. There is a family room with a fireplace and built-ins. The foldback stairs have a large window looking out to provide plenty of natural light in this two story space.