

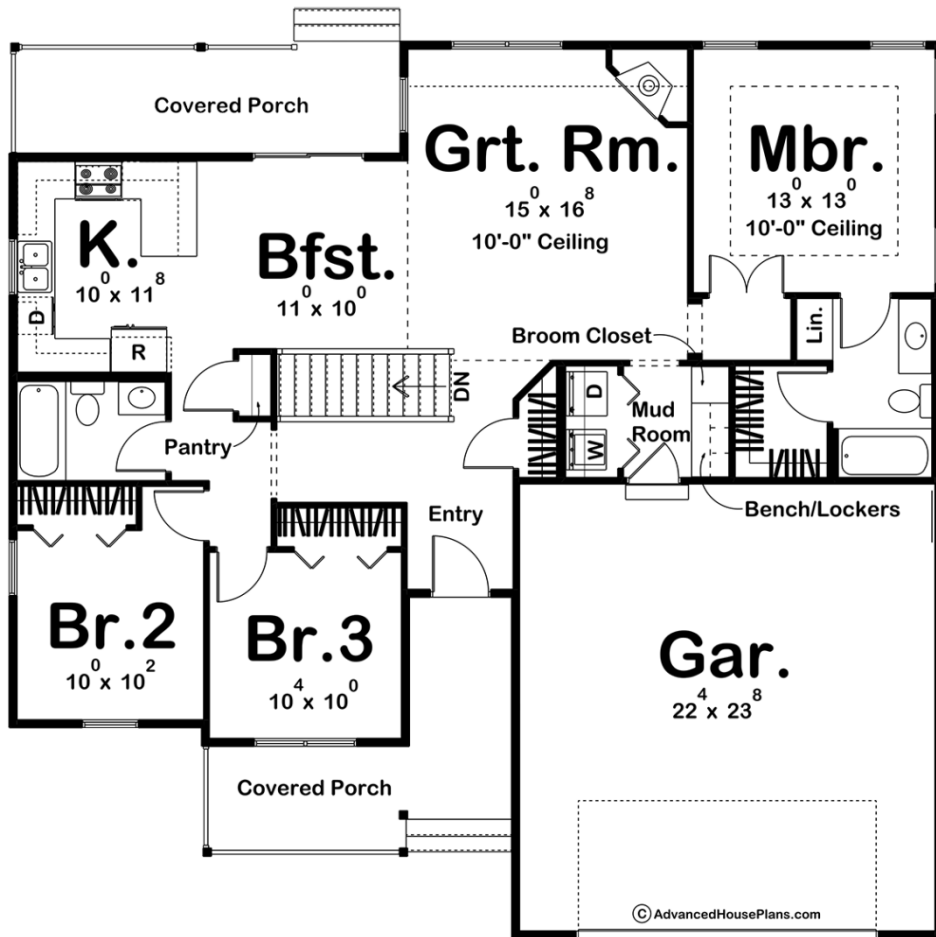

**29149 - Broomfield Data Sheet**

1381 SQ FT	3 BEDS	2 BATHS	2 BAYS	50' 0" WIDE	48' 0" DEEP
---------------	-----------	------------	-----------	----------------	----------------



**Construction Specs**

Layout

Bedrooms

Bathrooms	2
-----------	---

Garage Bays	2
-------------	---

### Square Footage

Main Level	1381 Sq. Ft.
------------	--------------

Garage	550 Sq. Ft.
--------	-------------

Total Finished Area	1381 Sq. Ft.
---------------------	--------------

### Exterior Dimensions

Width	50' 0"
-------	--------

Depth	48' 0"
-------	--------

Ridge Height	20' 0"
--------------	--------

*Calculated from main floor line*

### Default Construction Stats

*Stats are unique to the individual plan.*

Foundation Type	Basement
-----------------	----------

Exterior Wall Construction	2x4
----------------------------	-----

Roof Pitches	6/12 Primary, 10/12 Secondary
--------------	-------------------------------

Foundation Wall Height	9'
------------------------	----

Main Wall Height	9'
------------------	----

## Plan Description

If you are looking for an affordable house plan that still includes everything you could need in a home, you found it! The Broomfield plan comes in at just under 1400 sq ft and includes a 2-car garage. A front-covered porch greets guests into the home. The great room includes a built-in entertainment center that is flanked by built-in bookshelves. A corner fireplace warms the great room. The kitchen includes a pantry and ample counter space. A bar separates the kitchen and breakfast area. The master bedroom includes a decorative trayed ceiling and a walk-in closet. The home's 2-car garage accesses the main living space through a convenient mudroom that features a bench and lockers.