

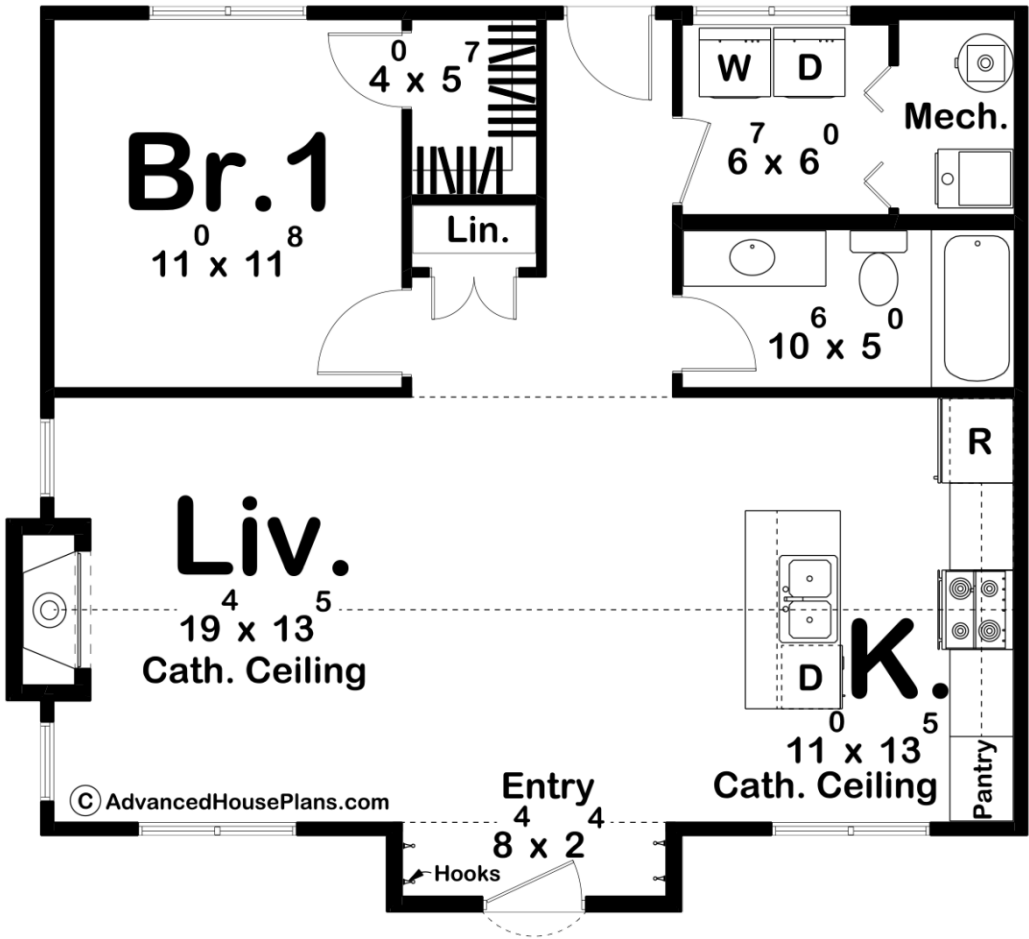

30543 - Brooklyn Data Sheet

797 SQ FT	1 BEDS	1 BATHS	0 BAYS	32' 0" WIDE	28' 4" DEEP
--------------	-----------	------------	-----------	----------------	----------------



Construction Specs

Layout

Bedrooms

Square Footage

Main Level	797 Sq. Ft.
Total Finished Area	797 Sq. Ft.

Exterior Dimensions

Width	32' 0"
Depth	28' 4"

Default Construction Stats

Stats are unique to the individual plan.

Foundation Type	Slab
Exterior Wall Construction	2x4
Roof Pitches	Primary 10/12, Secondary 14/12
Main Wall Height	9'

Plan Description

Welcome to your cozy modern cottage-style ADU, a perfect blend of functionality and charm. This thoughtfully designed space features one bedroom, one bathroom, an inviting entry area, and a convenient laundry room.As you step through the front door, you're greeted by a warm and welcoming entry space adorned with hooks for hanging coats, hats, and bags. This area serves as a practical transition zone, allowing you to easily shed the day's belongings before entering the main living area.Adjacent to the living area, you'll find a cozy bedroom that features a walk-in closet.In summary, this modern cottage-style ADU offers everything you need for comfortable and convenient living in a compact footprint. With its thoughtful design, stylish finishes, and functional amenities, it's the perfect place to call home.