

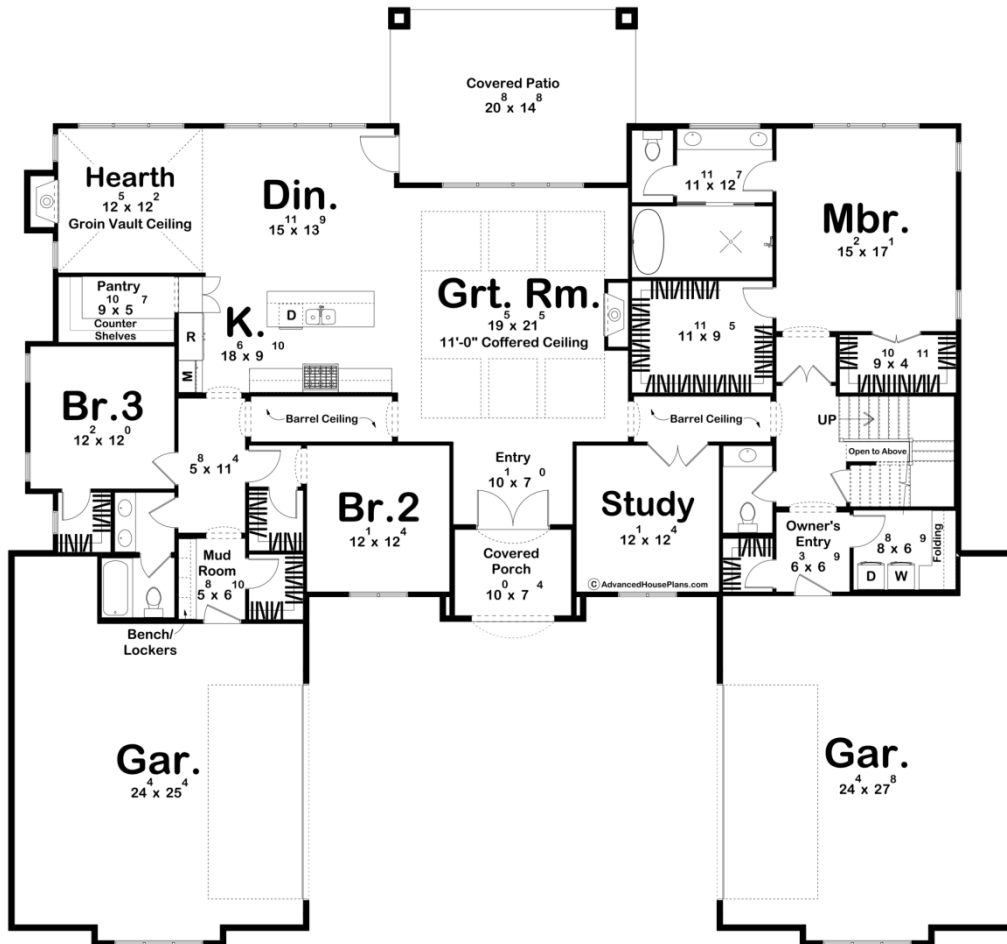

**30298 - Blackwood Data Sheet**

2938 SQ FT	3 BEDS	3 BATHS	4 BAYS	84' 8" WIDE	78' 8" DEEP
---------------	-----------	------------	-----------	----------------	----------------

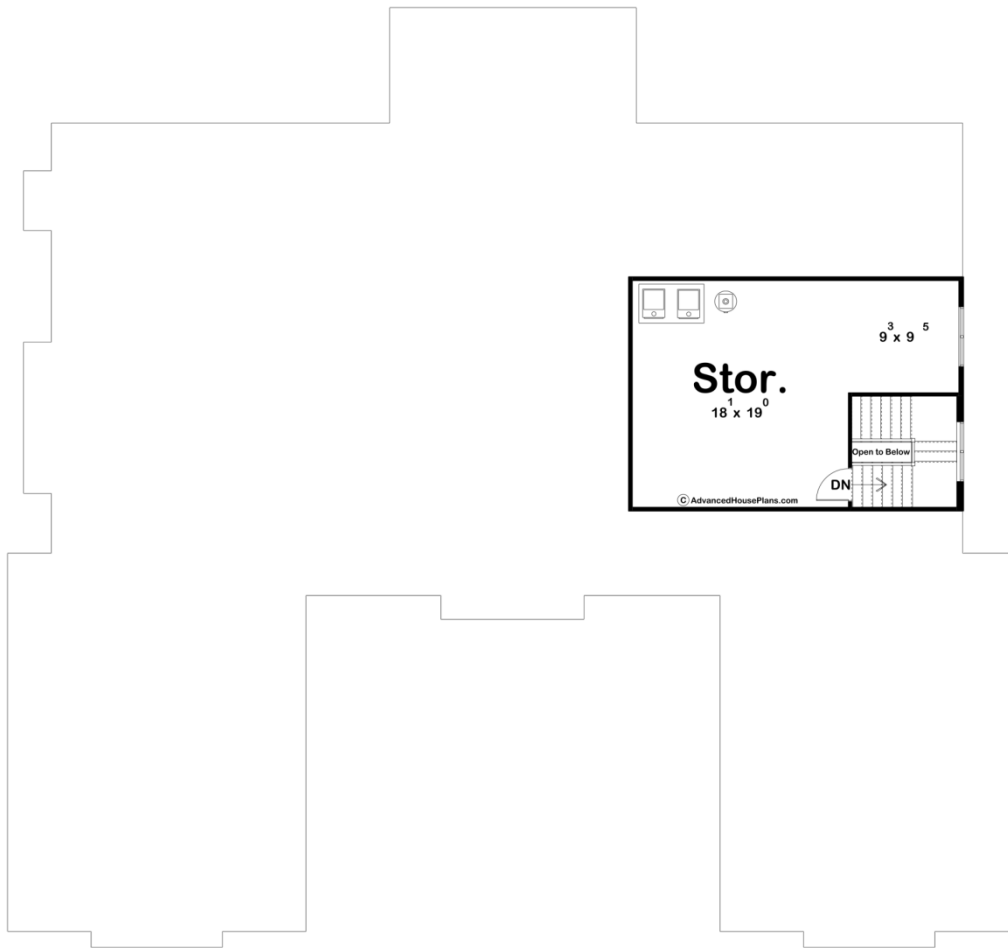



## Construction Specs

### Layout

Bedrooms	3
Bathrooms	3
Garage Bays	4

### Square Footage

Main Level	2938 Sq. Ft.
Covered Area	376 Sq. Ft.
Garage	1429 Sq. Ft.
Total Finished Area	2938 Sq. Ft.

### Exterior Dimensions

Width	84' 8"
Depth	78' 8"

### Default Construction Stats

*Stats are unique to the individual plan.*

Foundation Type	Slab
-----------------	------

Exterior Wall Construction	2x4
Roof Pitches	Primary 10/12, Secondary 14/12, 4/12
Main Wall Height	10'

## Plan Description

This Modern Cottage-style house plan features a timeless and balanced design, showcasing a brick exterior that exudes warmth and classic charm. The facade is adorned with wood shutters, adding a touch of traditional elegance to the overall aesthetic. On both sides of the house, spacious garages provide ample parking space while helping the home maintain a cohesive and harmonious look. Upon entering through the covered stoop, you are greeted by an open floor plan that seamlessly connects various living spaces. The hearth room serves as a cozy retreat, featuring a fireplace that adds both warmth and a touch of old-world charm to the interior. The layout emphasizes an openness that is great for entertaining. The master suite boasts his and hers closets, offering convenient and well-organized storage space. Ascending to the second level, you'll discover a dedicated storage room, providing additional space for belongings. Overall, this colonial-style house plan combines classic architectural elements with modern functionality, creating a welcoming and comfortable home for residents.