

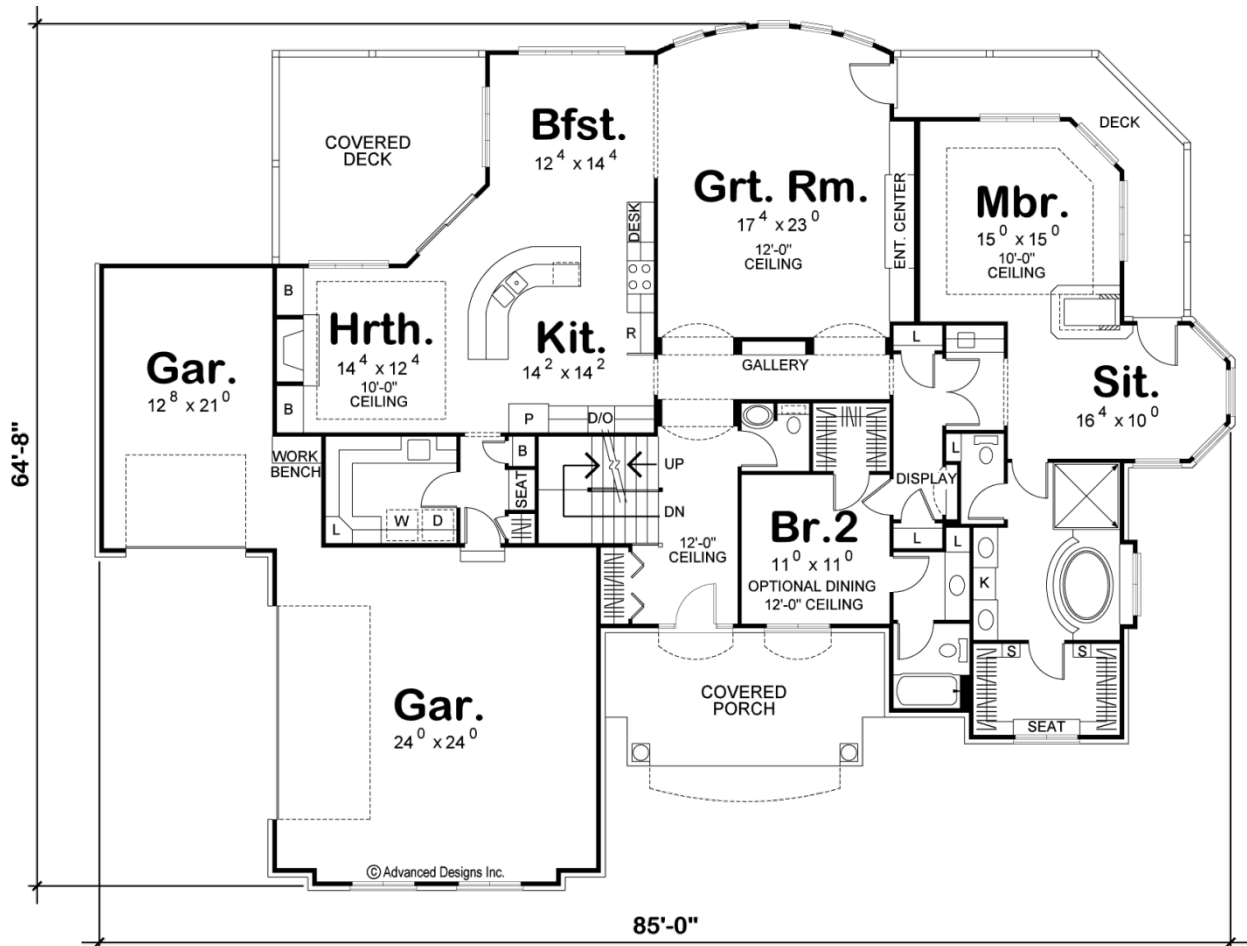

**29129 - Baxter Data Sheet**

2494 SQ FT	2 BEDS	2 BATHS	4 BAYS	86' 0" WIDE	66' 0" DEEP
---------------	-----------	------------	-----------	----------------	----------------



**Construction Specs**

Layout

Bedrooms

Bathrooms	2
Garage Bays	4

### Square Footage

Main Level	2494 Sq. Ft.
Garage	1433 Sq. Ft.
Total Finished Area	2494 Sq. Ft.

### Exterior Dimensions

Width	86' 0"
Depth	66' 0"
Ridge Height <i>Calculated from main floor line</i>	29'

### Default Construction Stats

*Stats are unique to the individual plan.*

Foundation Type	Basement
Exterior Wall Construction	2x4
Roof Pitches	6/12
Foundation Wall Height	9'
Main Wall Height	9'
Second Wall Height	8'

## Plan Description

A sophisticated array of gables, textures and special architectural details are beautifully orchestrated on this 2,494 sq. ft., 1-story house plan. Guests are welcomed by a deep, covered front porch that opens to an entry hall with a 12-foot-high ceiling and coat closet. A few steps farther inside pass through a gallery hall and into the great room with its built-in entertainment center and an impressive bank of rear windows. The sunny breakfast room lies open to the great room and accesses a covered deck that offers expanded dining options. A seamless connection adjoins the breakfast room with the kitchen and hearth room, which features built-in bookshelves and, of course, a cozy fireplace. The kitchen itself boasts a curved island workspace, ample counter space, pantry and built-in desk. Just off the kitchen lies a utility area that includes a laundry room with counters and sink, as well as a mud area with built-in seat and coat closet. This area accesses the home's 3-car garage, which consists of a side-load, 2-car garage and a front-load, 1-car garage. A built-in workbench is positioned between the two garage areas. Double doors at the end of the gallery hall lead into the master suite. The bedroom and a bayed sitting area are separated by a fabulous see-thru fireplace. A wrapping deck -- perfectly complemented by a morning cup of coffee -- is accessed from the sitting room. The bath area offers pampering amenities that include his-and-her vanities, oval soaking tub, shower, compartmented toilet and walk-in closet with built-in seat. Bedroom 2 features a walk-in closet and enjoys its own bath. This bedroom also opts as a dining room, due to its proximity to the front entry area. Another optional living space is found above the 2-car garage, where a 390 sq. ft. flex room -- possibly a private den -- can be built and accessed from the entry area's stairway.