

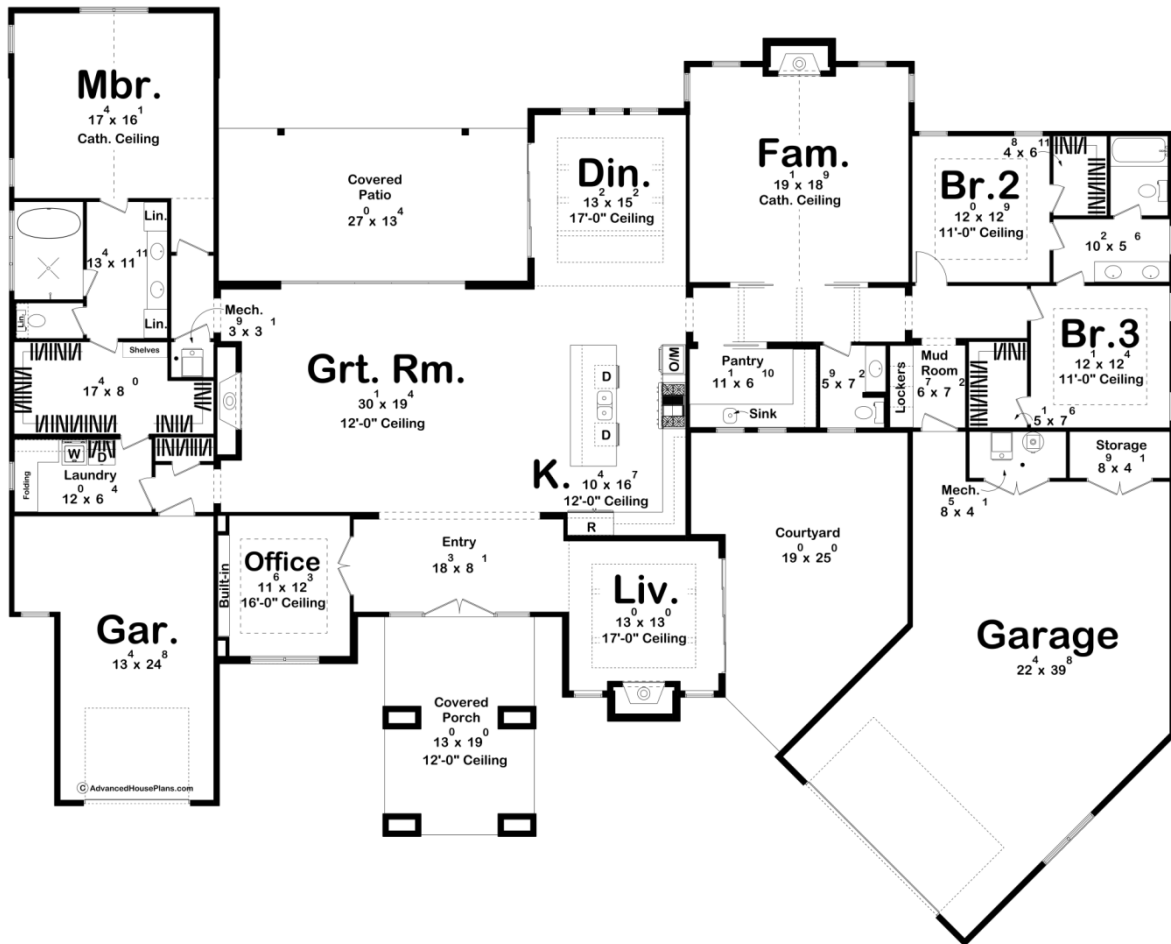

30465 - Arlington Data Sheet

| | | | | | |
|---------------|-----------|------------|-----------|-----------------|----------------|
| 3584 SQ FT | 3 BEDS | 3 BATHS | 3 BAYS | 101' 0" WIDE | 81' 2" DEEP |
|---------------|-----------|------------|-----------|-----------------|----------------|



Construction Specs

Layout

Bedrooms

| | |
|-------------|---|
| Bathrooms | 3 |
| Garage Bays | 3 |

Square Footage

| | |
|---------------------|--------------|
| Main Level | 3584 Sq. Ft. |
| Covered Area | 605 Sq. Ft. |
| Garage | 1279 Sq. Ft. |
| Total Finished Area | 3584 Sq. Ft. |

Exterior Dimensions

| | |
|--|---------|
| Width | 101' 0" |
| Depth | 81' 2" |
| Ridge Height <i>Calculated from main floor line</i> | 24' 10" |

Default Construction Stats

Stats are unique to the individual plan.

| | |
|----------------------------|------------------------------------|
| Foundation Type | Slab |
| Exterior Wall Construction | 2x4 |
| Roof Pitches | Primary 8/12, Secondary 6/12, 5/12 |
| Main Wall Height | 10' |

Plan Description

The Arlington is a stunning Texas Hillside home blending classic style with modern elegance. Inside, grand ceilings define the spaces—a 17' ceiling with faux wood beams in the living room, cathedral ceilings in the family room and master bedroom, and a soaring 16' ceiling in the office. The master suite offers a serene retreat with a spa-like bathroom featuring a unique tub-in-shower design and an oversized walk-in closet. For everyday ease, enjoy the walk-in pantry, mudroom, and dedicated laundry room. Outside, relax on the expansive covered patio or courtyard, making this 3-bed, 3-bath haven perfect for entertaining and unwinding.