

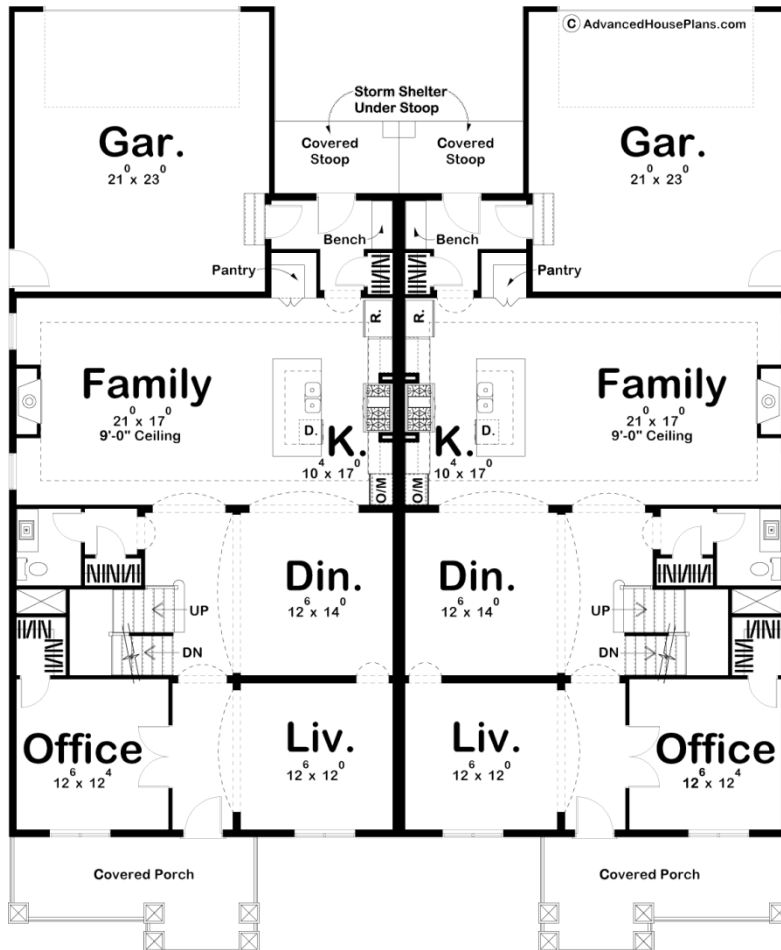

**29360 - Arbor Gate Data Sheet**

3002 SQ FT	4 BEDS	4 BATHS	2 BAYS	64' 0" WIDE	78' 0" DEEP
---------------	-----------	------------	-----------	----------------	----------------

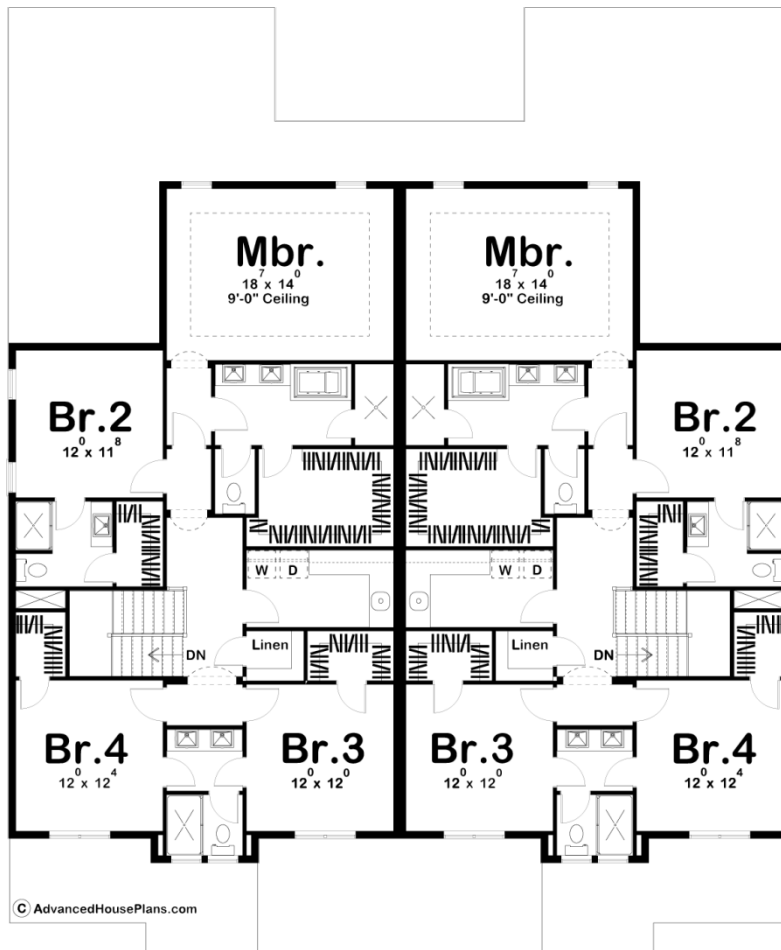



## Construction Specs

### Layout

Bedrooms	4
Bathrooms	4
Garage Bays	2

### Square Footage

Main Level	1506 Sq. Ft.
Second Level	1496 Sq. Ft.
Garage	504 Sq. Ft.
Total Finished Area	3002 Sq. Ft.

### Exterior Dimensions

Width	64' 0"
Depth	78' 0"
Ridge Height	30' 0"
<i>Calculated from main floor line</i>	

## Default Construction Stats

*Stats are unique to the individual plan.*

Foundation Type	Basement
Exterior Wall Construction	2x4
Roof Pitches	6/12
Foundation Wall Height	9'
Main Wall Height	9'
Second Wall Height	8'

## Plan Description

Solid Craftsman styling on the outside and sleek, fluid room arrangements on the inside make this 3,002 sq. ft. multi-family house plan an attractive choice. Stout columns occupy the front covered porch, where upon entering the home, guests are greeted by views into a living room on one side and a home office on the other. The office, accessed through French doors, features a walk-in closet and has views to the front. A pass-through connects the living room and dining room, which lies just a few steps farther inside. Adjoining the dining room is the kitchen, with its island breakfast bar and pantry. The kitchen lies open to the family room, which showcases a fireplace flanked by windows. Just off the kitchen, a mud room with bench and coat closet accesses the 2-car garage, as well as a covered stoop that sits atop a storm shelter below. Upstairs, the master suite enjoys privacy from the secondary bedrooms and features a bathroom with dual sinks, soaking tub, shower, compartmented toilet and large walk-in closet. All of the secondary bedrooms feature walk-in closets. Bedroom 2 has its own bath, while bedrooms 3 and 4 share a Jack-n-Jill bath. A centrally located laundry with soaking sink and generous counter space conveniently serves all bedrooms.