

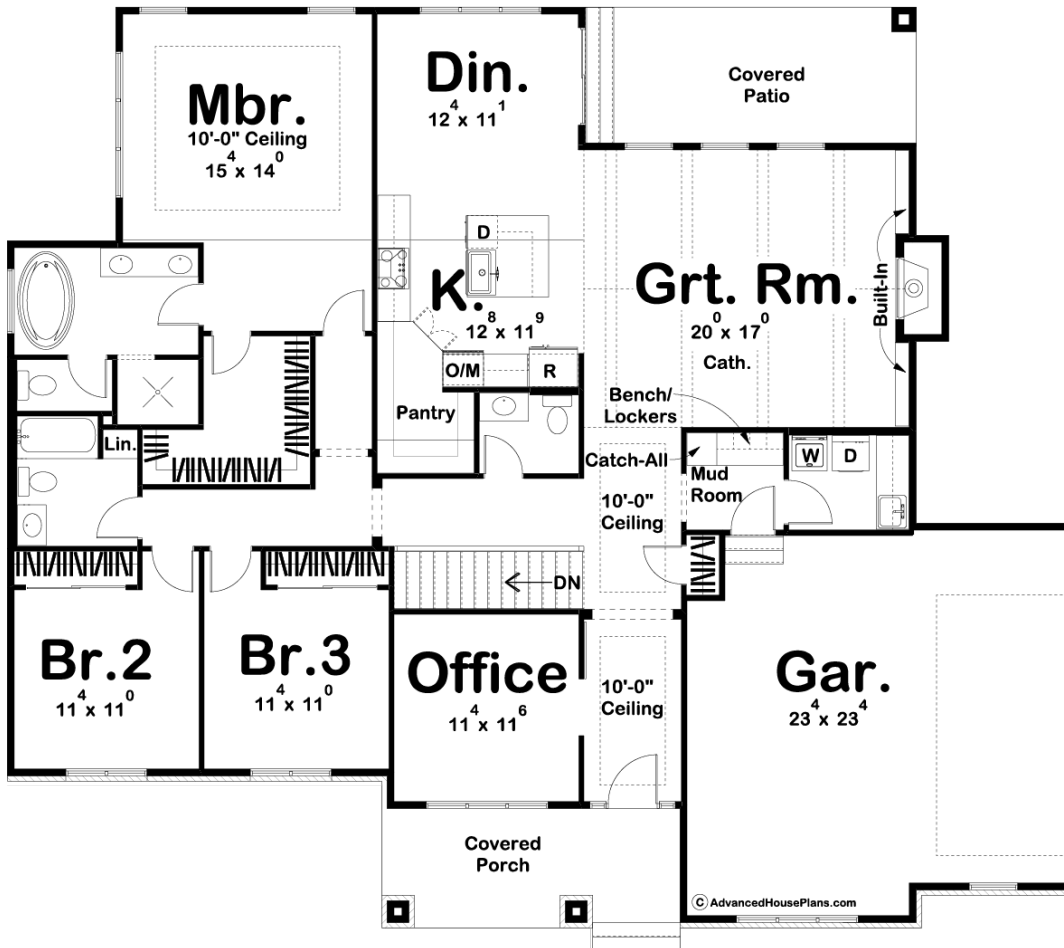

29638 - Ameer Data Sheet

2191 SQ FT	3 BEDS	3 BATHS	2 BAYS	66' 0" WIDE	56' 0" DEEP
---------------	-----------	------------	-----------	----------------	----------------



Construction Specs

Layout

Bedrooms

Bathrooms	3
-----------	---

Garage Bays	2
-------------	---

Square Footage

Main Level	2191 Sq. Ft.
------------	--------------

Garage	541 Sq. Ft.
--------	-------------

Total Finished Area	2191 Sq. Ft.
---------------------	--------------

Exterior Dimensions

Width	66' 0"
-------	--------

Depth	56' 0"
-------	--------

Default Construction Stats

Stats are unique to the individual plan.

Foundation Type	Basement
-----------------	----------

Exterior Wall Construction	2x4
----------------------------	-----

Roof Pitches	6/12 Primary, 4/12 Secondary
--------------	------------------------------

Foundation Wall Height	9'
------------------------	----

Main Wall Height	9'
------------------	----

Plan Description

The Ameer is an elegant balance of beautiful design and cost-saving simplicity making it an attractive option for builders and homeowners alike. The plan features open living spaces and a side-load garage. The over-sized Master Suite has 10' ceilings and a generous walk-in closet. The master bath includes a free standing tub and enclosed toilet area. Homeowners will love to show off their great room with a cathedral ceiling and wood beams along with beautiful built-in bookshelves. The kitchen includes a large walk-in pantry and an island. A convenient office in the front of the house is a perfect space to get things done from the comfort of your own home.