

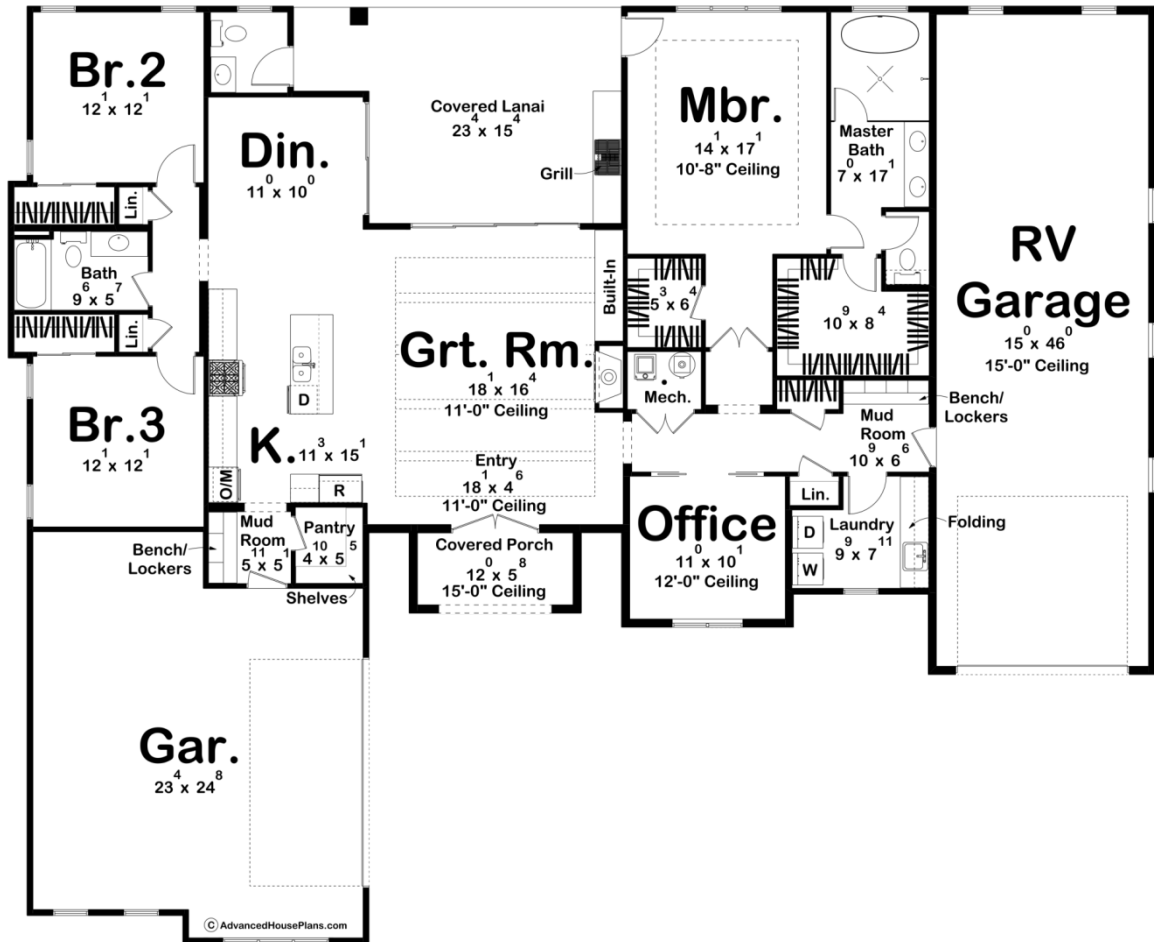

30308 - Altman Data Sheet

2230 SQ FT	3 BEDS	3 BATHS	3 BAYS	81' 0" WIDE	66' 0" DEEP
---------------	-----------	------------	-----------	----------------	----------------



Construction Specs

Layout

Bedrooms

Bathrooms	3
-----------	---

Garage Bays	3
-------------	---

Square Footage

Main Level	2230 Sq. Ft.
------------	--------------

Covered Area	376 Sq. Ft.
--------------	-------------

Garage	1359 Sq. Ft.
--------	--------------

Total Finished Area	2230 Sq. Ft.
---------------------	--------------

Exterior Dimensions

Width	81' 0"
-------	--------

Depth	66' 0"
-------	--------

Default Construction Stats

Stats are unique to the individual plan.

Foundation Type	Slab
-----------------	------

Exterior Wall Construction	2x4
----------------------------	-----

Roof Pitches	4/12 Primary
--------------	--------------

Main Wall Height	10'
------------------	-----

Plan Description

The Altman is a handsome 3 bed, 3 bath, 3 car garage home. The low pitches and contrasting stucco give this home amazing curb appeal. On the inside, you are greeted by a large entry that opens into the great room. The 11 foot tray ceiling has exposed beams in it. The great room flows into the kitchen and the dining room. The kitchen has a walk-in pantry off the mudroom. The left side of the home has two bedrooms that share a hall bath. The right side of the home houses the master suite. It includes two walk-in closets, a shower room, and a dual vanity. There is an office and another mudroom coming in from the RV garage. The laundry room is located off of the mudroom. This home has a 2 car garage on the left side while the right side has an RV garage with an oversized overhead door. At the rear, there is a large covered lanai that has a built in grill and access to a bathroom.