

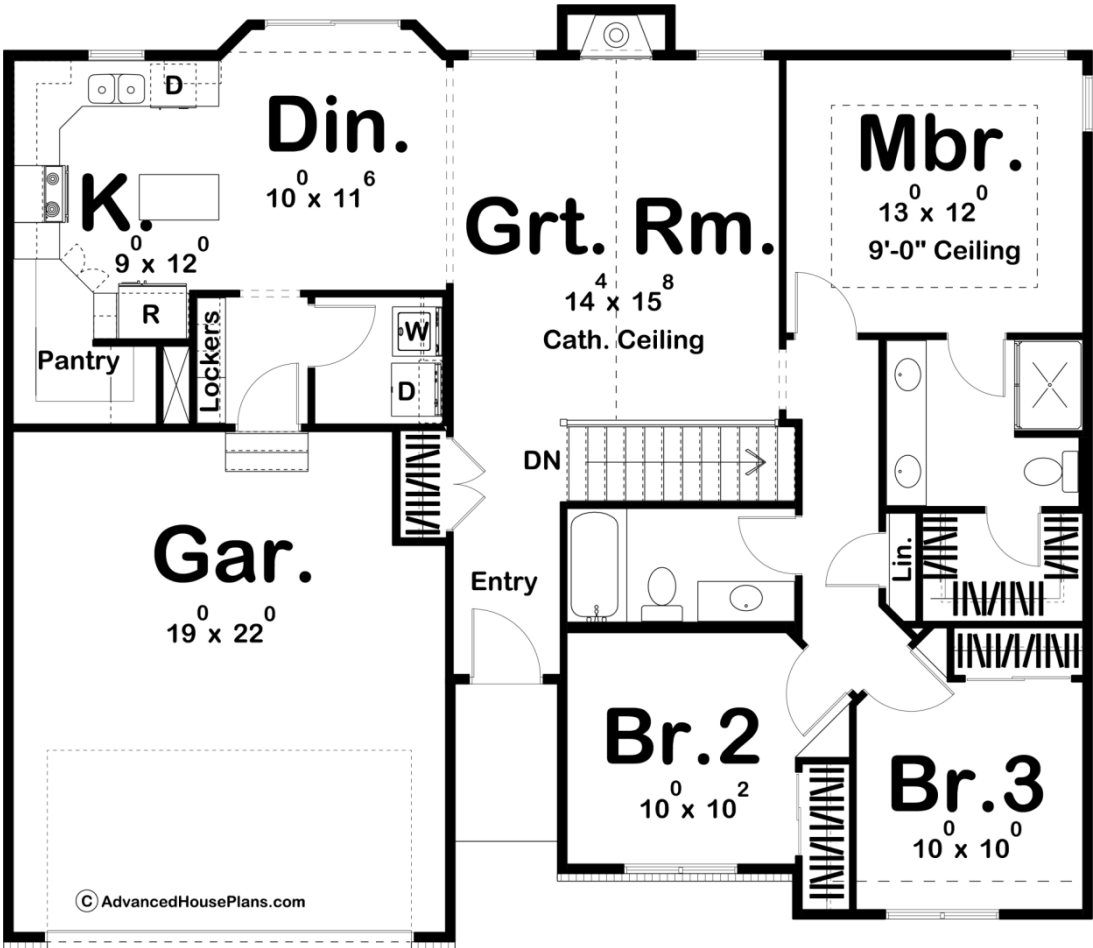

29059 - Springhill Data Sheet

1343 SQ FT	3 BEDS	2 BATHS	2 BAYS	47' 8" WIDE	41' 0" DEEP
---------------	-----------	------------	-----------	----------------	----------------



Construction Specs

Layout

Bedrooms

Bathrooms	2
Garage Bays	2
Square Footage	
Main Level	1343 Sq. Ft.
Garage	423 Sq. Ft.
Total Finished Area	1343 Sq. Ft.
Exterior Dimensions	
Width	47' 8"
Depth	41' 0"
Ridge Height <i>Calculated from main floor line</i>	22'
Default Construction Stats <i>Stats are unique to the individual plan.</i>	
Foundation Type	Basement
Exterior Wall Construction	2x4
Roof Pitches	8/12
Foundation Wall Height	9'
Main Wall Height	9'

Plan Description

The Springhill plan makes great use of it's small space to create a fantastic simple house. As you walk through the entryway you will see a large great room with a soaring cathedral ceiling. The great room is warmed by a fireplace and lets in a lot of natural light with windows to the back yard. The dining room flows into a beautiful kitchen with an island and a walk in pantry. On the right side of the home you will find a wonderful master suite complete with his/her vanities, a walk in shower and a walk in closet. Bedrooms 2 and 3 share a centrally located hall bathroom. The house is also accessible from the 2 car garage through a simple and practical mudroom with lockers. This house is sure to impress at it's small 1343 sq. ft. footprint.