

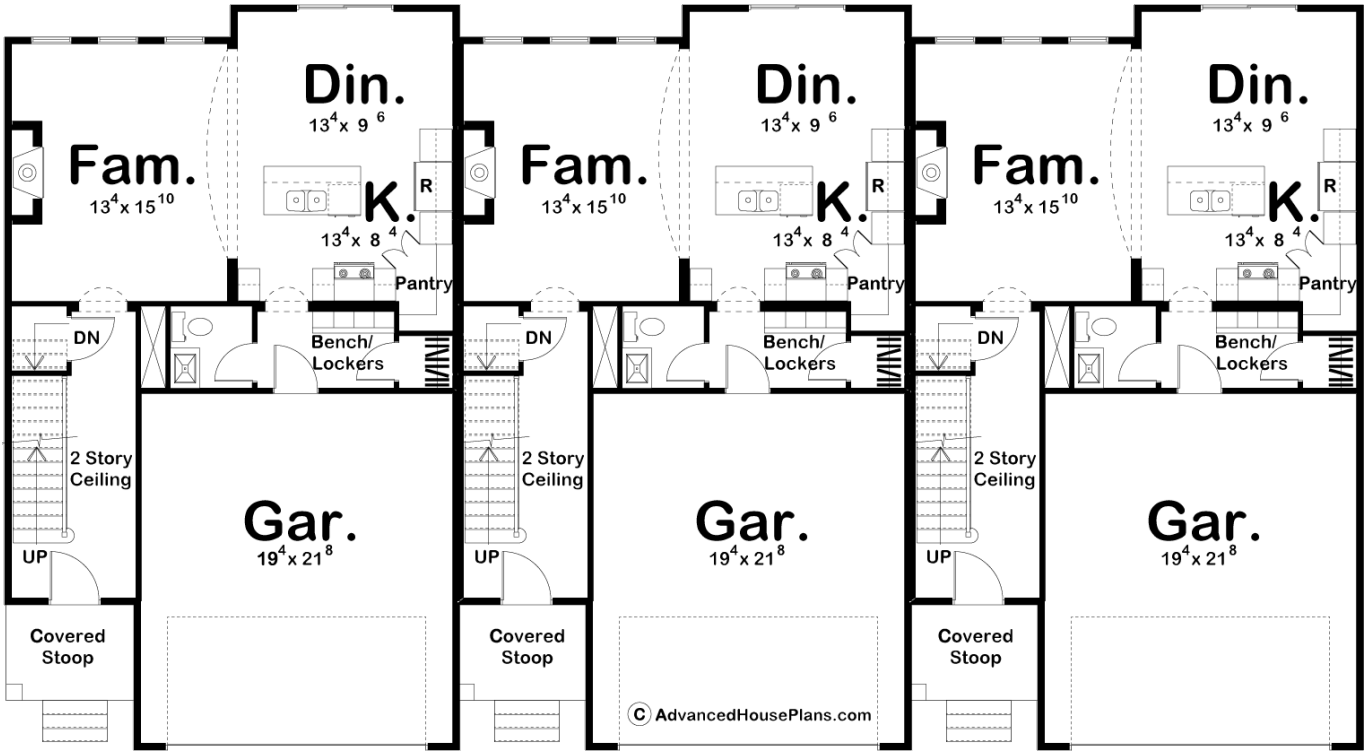

29322 - Morehead Data Sheet

1676 SQ FT	3 BEDS	3 BATHS	2 BAYS	84' 0" WIDE	46' 0" DEEP
---------------	-----------	------------	-----------	----------------	----------------

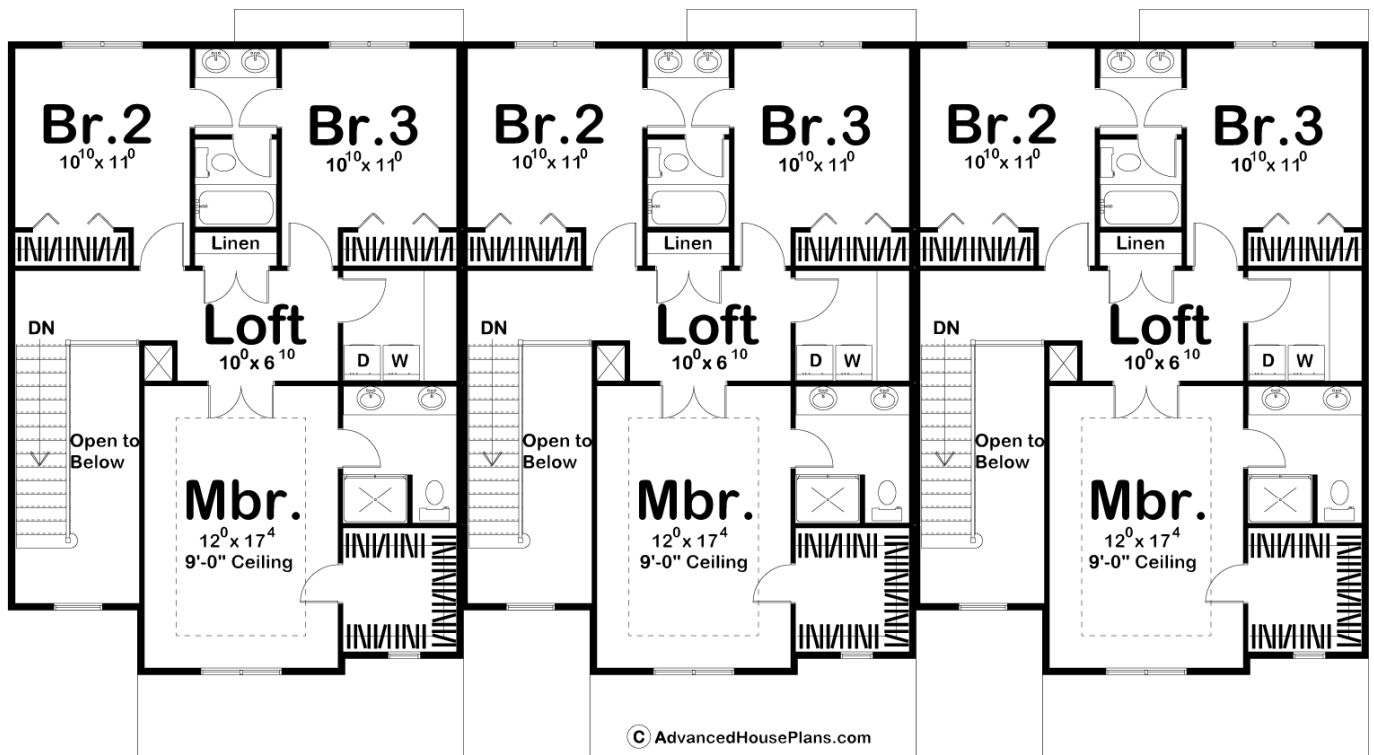



Construction Specs

Layout

Bedrooms	3
Bathrooms	3
Garage Bays	2

Square Footage

Main Level	757 Sq. Ft.
Second Level	919 Sq. Ft.
Garage	434 Sq. Ft.
Total Finished Area	1676 Sq. Ft.

Exterior Dimensions

Width	84' 0"
Depth	46' 0"
Ridge Height	34'
<i>Calculated from main floor line</i>	

Default Construction Stats
Stats are unique to the individual plan.

Foundation Type	Basement
Exterior Wall Construction	2x4
Roof Pitches	8/12 Primary, 6/12 Secondary
Foundation Wall Height	9'
Main Wall Height	9'
Second Wall Height	8'

Plan Description

Traditional styling and family-friendly room arrangements have made this 2-story, multi-family house plan a favorite choice. A 2-story-high entry hall greets guests and leads them to the family room, with fireplace and sunny windows to the rear. Open to the family room are the dining area and the kitchen, which features an island work area and walk-in pantry. Just off the kitchen, a mud room with bench, lockers and adjacent powder bath, intercepts clutter and accesses the 2-car garage. Upstairs, a loft area with views to the entry below, introduces the master suite through double doors. The suite features a generous walk-in closet and a bath area with dual sinks. Bedrooms 2 and 3 share a Jack-n-Jill bath. All bedrooms are served by a centrally located linen closet and laundry area. As always any Advanced House Plans home plan can be customized to fit your needs with our alteration department. Whether you need to add another garage stall, change the front elevation, stretch the home larger or just make the home plan more affordable for your budget we can do that and more for you at Ahp. Unless you purchase an unlimited use license or a multi-use license you may only build one home from a set of plans. Plans cannot be re-sold.