

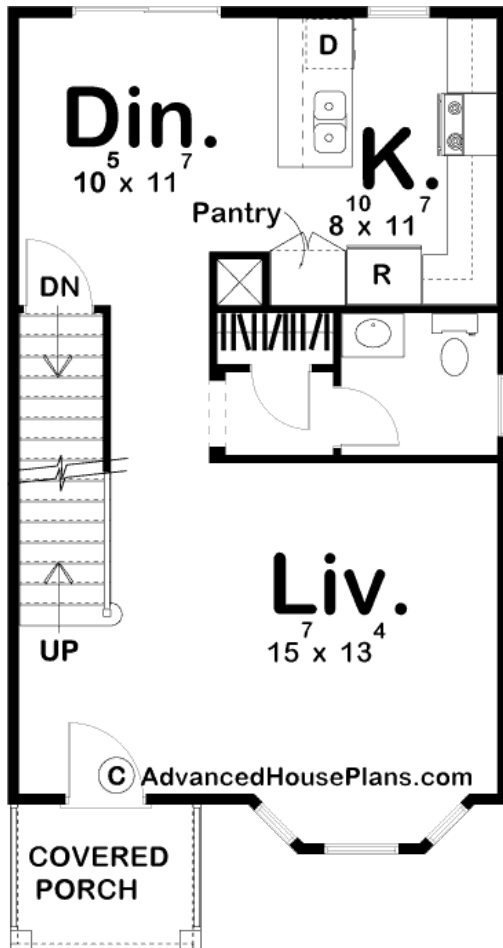

### 29367 - McLaren Data Sheet

1256 SQ FT	2 BEDS	3 BATHS	0 BAYS	20' 0" WIDE	38' 0" DEEP
---------------	-----------	------------	-----------	----------------	----------------

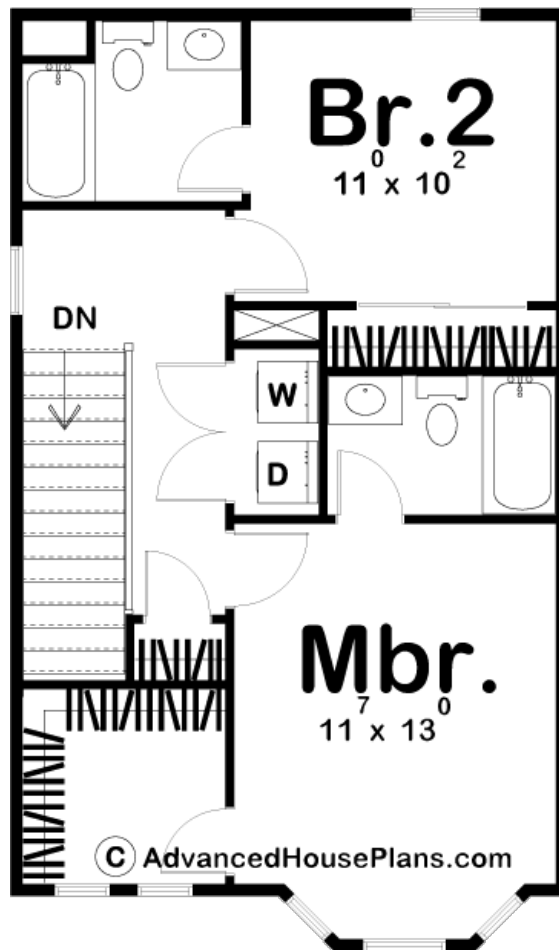



## Construction Specs

### Layout

Bedrooms	2
Bathrooms	3

### Square Footage

Main Level	654 Sq. Ft.
Second Level	602 Sq. Ft.
Total Finished Area	1256 Sq. Ft.

### Exterior Dimensions

Width	20' 0"
Depth	38' 0"
Ridge Height	31'
<i>Calculated from main floor line</i>	

### Default Construction Stats

*Stats are unique to the individual plan.*

Foundation Type	Basement
-----------------	----------

Exterior Wall Construction	2x4
Roof Pitches	6/12 primary, 12/12, 10/12, 4/12 Secondary
Foundation Wall Height	9'
Main Wall Height	9'
Second Wall Height	8'

## Plan Description

Quaint, compact and charming" describes the character of this eye-catching, narrow lot house plan. The design's nostalgically styled front elevation is accentuated by double-stacked bayed windows, a covered front porch and a tasteful rooftop dormer. On the inside, visitors are offered immediate views of the formal living room, which is brightened by a trio of bayed windows. Farther inside, beyond the coat closet alcove and powder bath, the dining area lies open to the kitchen, which includes a breakfast island and pantry. Upstairs, the master bedroom enjoys elevated views through its bayed windows. A nicely sized walk-in closet is brightened by two windows. Bedroom 2 is situated for privacy from the master bedroom and enjoys its own bath. A central laundry area and linen closet lie opposite the stairway's banister. Check out our other small house plans! As always any Advanced House Plans home plan can be customized to fit your needs with our alteration department. Whether you need to add another garage stall, change the front elevation, stretch the home larger or just make the home plan more affordable for your budget we can do that and more for you at Ahp.