

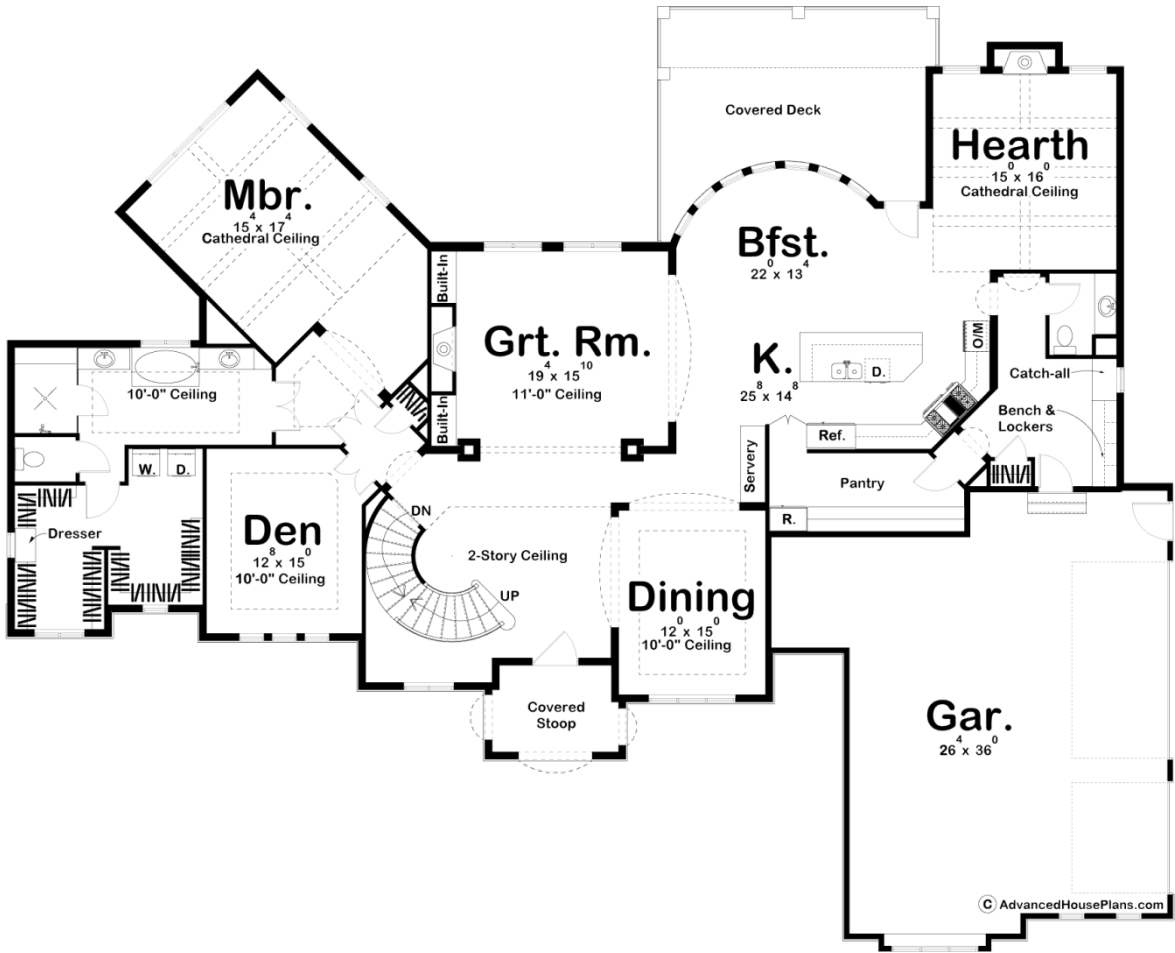

29356 - Maplewood Data Sheet

|               |           |            |           |                |                |
|---------------|-----------|------------|-----------|----------------|----------------|
| 5088<br>SQ FT | 5<br>BEDS | 5<br>BATHS | 3<br>BAYS | 95' 0"<br>WIDE | 77' 0"<br>DEEP |
|---------------|-----------|------------|-----------|----------------|----------------|

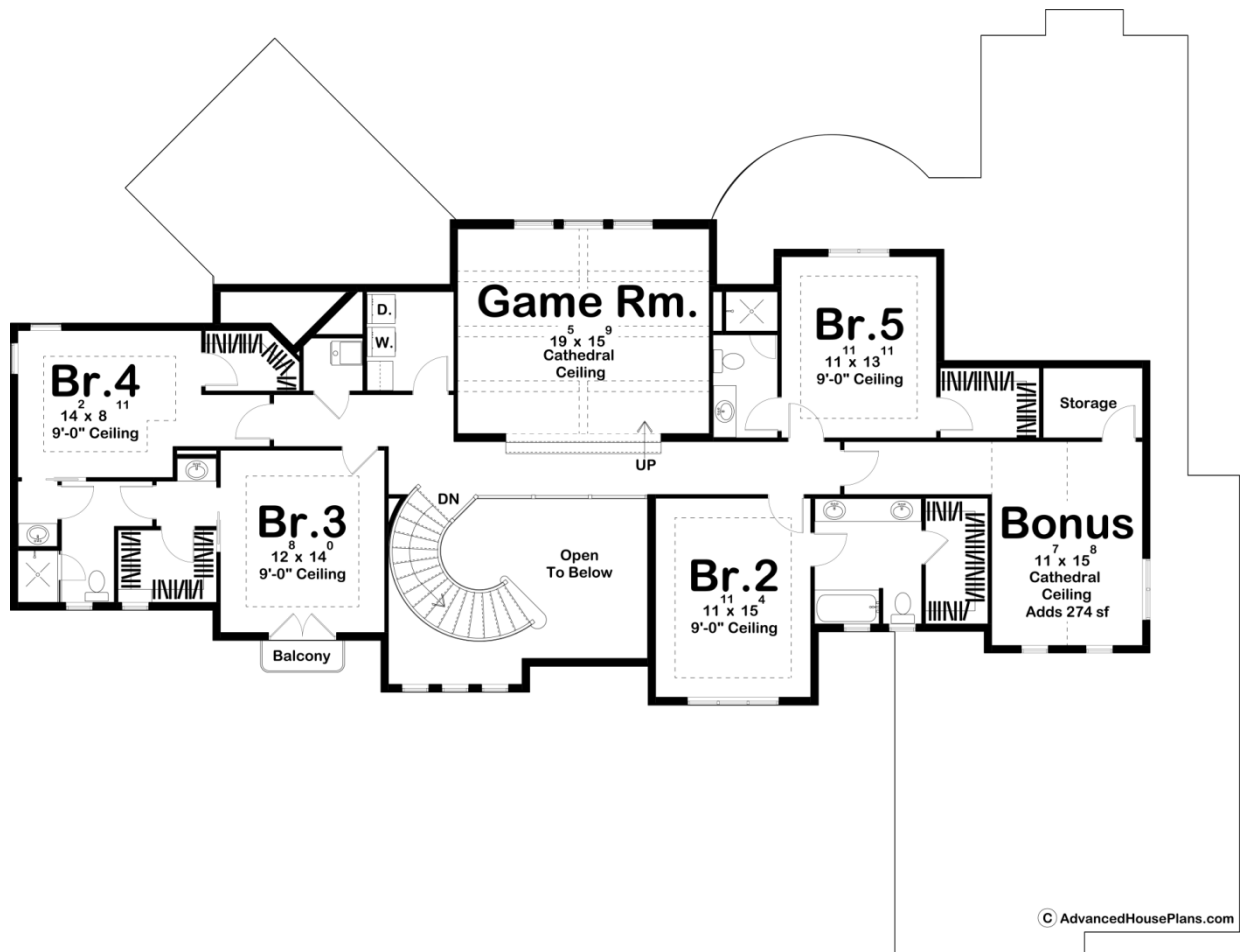



## Construction Specs

### Layout

|             |   |
|-------------|---|
| Bedrooms    | 5 |
| Bathrooms   | 5 |
| Garage Bays | 3 |

### Square Footage

|                     |              |
|---------------------|--------------|
| Main Level          | 3173 Sq. Ft. |
| Second Level        | 1915 Sq. Ft. |
| Garage              | 970 Sq. Ft.  |
| Total Finished Area | 5088 Sq. Ft. |

### Exterior Dimensions

|  |        |
|--|--------|
| Width                                  | 95' 0" |
| Depth                                  | 77' 0" |
| Ridge Height                           | 30'    |
| <i>Calculated from main floor line</i> |        |

**Default Construction Stats**  
*Stats are unique to the individual plan.*

|                            |                              |
|----------------------------|------------------------------|
| Foundation Type            | Basement                     |
| Exterior Wall Construction | 2x6                          |
| Roof Pitches               | Primary 6/12, Secondary 4/12 |
| Foundation Wall Height     | 9'                           |
| Main Wall Height           | 10'                          |
| Second Wall Height         | 8'                           |

**Plan Description**

Classic Mediterranean-style accents enhance the curb appeal of this remarkable 1.5-story house plan. Upon entry through the front covered stoop, guests are treated to stunning views of an impressive half-round staircase, set beneath a 2-story-high ceiling. Farther inside, a pair of matching columns beckon entry into the great room, with its fireplace and built-in bookcases. The great room affords open views to the kitchen and breakfast area, which are brightened by a graceful arc of windows, facing the rear covered deck. The kitchen is well-appointed with generous counter space, a work island, walk-in pantry and adjoining servery. A hearth room lies by itself for cozy gatherings near its fireplace. The angled master suite enjoys seclusion from the main floor's living areas. Its bath area includes his and her walk-in closets with laundry, his and her vanities, and a large shower. Just off the master suite, a private den offers a quiet refuge. The house plan's second level is occupied by five bedrooms, a laundry area, a game room with cathedral ceiling and a sizeable bonus room with added storage. Each of the bedrooms includes a walk-in closet and bedrooms 2 and 5 enjoy their own bath. Back on the main level, a 3-car garage, with space for a work area, gains entry into the home through a practical mud room, complete with bench, lockers, coat closet, catch-all cover and powder bath.