

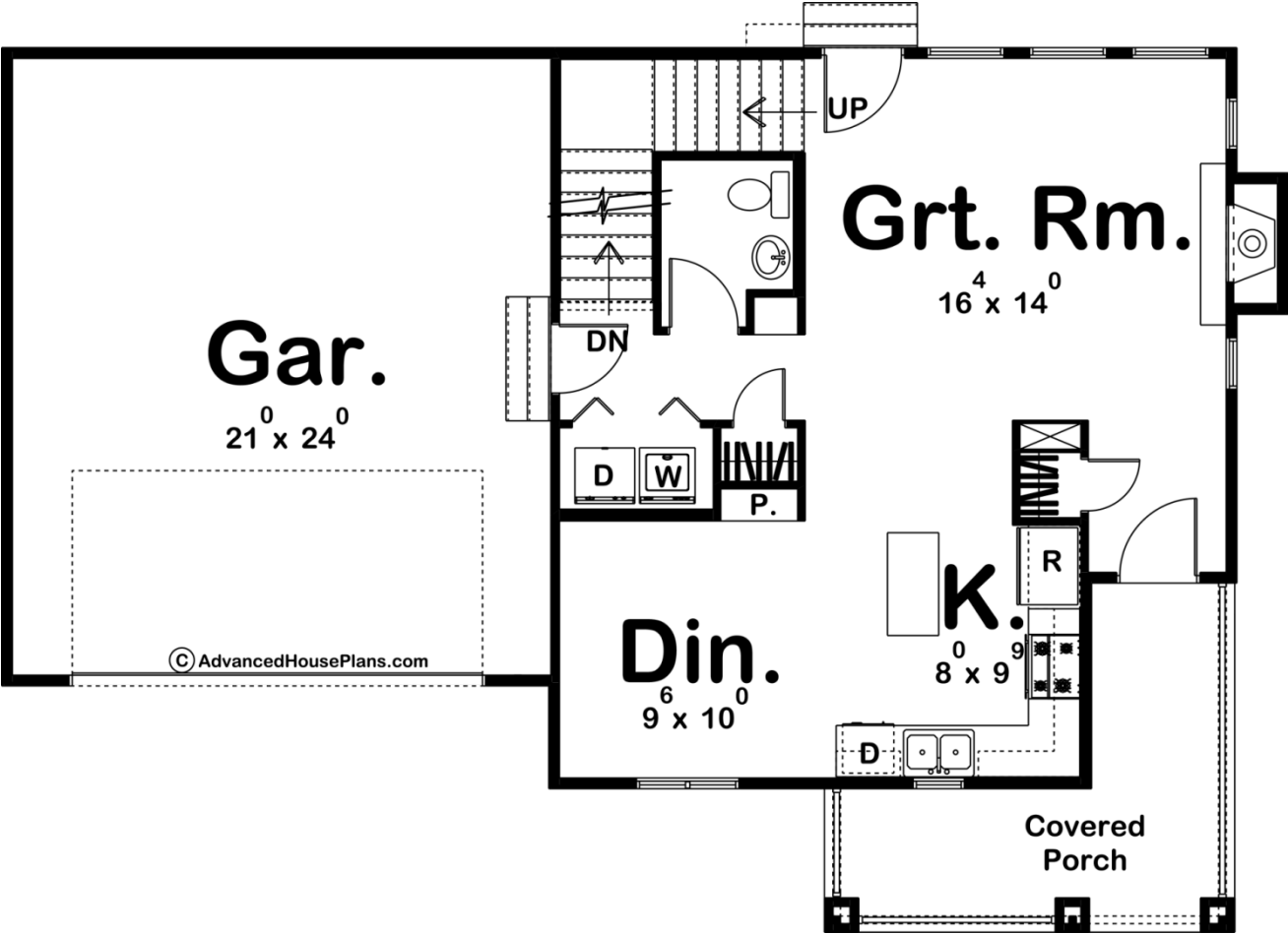

29174 - Hillenbrand Data Sheet

1399 SQ FT	3 BEDS	3 BATHS	2 BAYS	50' 0" WIDE	35' 0" DEEP
---------------	-----------	------------	-----------	----------------	----------------

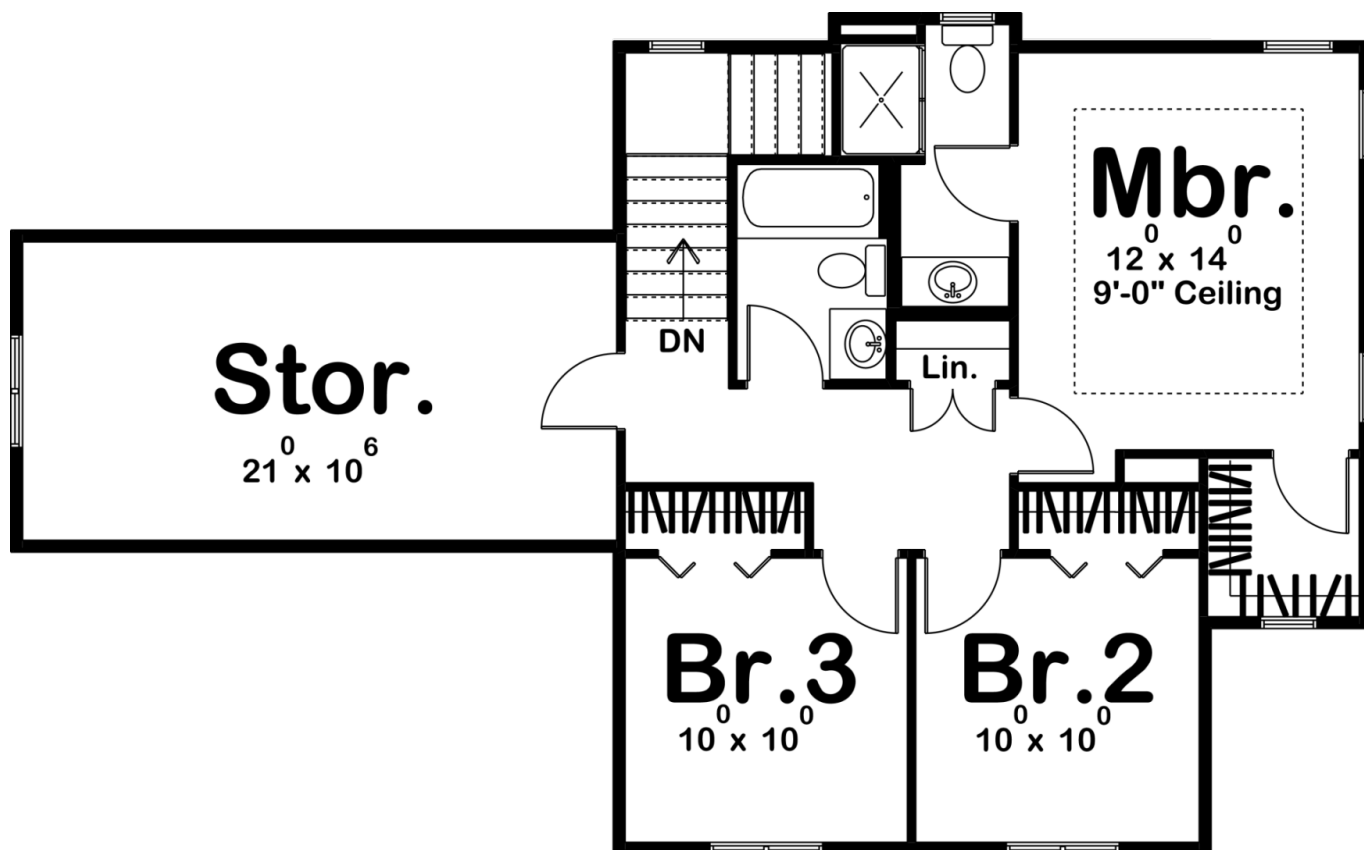



## Construction Specs

### Layout

Bedrooms	3
Bathrooms	3
Garage Bays	2

### Square Footage

Main Level	730 Sq. Ft.
Second Level	669 Sq. Ft.
Garage	526 Sq. Ft.
Total Finished Area	1399 Sq. Ft.

### Exterior Dimensions

Width	50' 0"
Depth	35' 0"
Ridge Height	27'
<i>Calculated from main floor line</i>	

**Default Construction Stats**  
*Stats are unique to the individual plan.*

Foundation Type	Basement
Exterior Wall Construction	2x4
Roof Pitches	Primary 6/12, Secondary 10/12
Foundation Wall Height	9'
Main Wall Height	9'
Second Wall Height	8'

**Plan Description**

Tasteful details enhance the charm of this Traditional style two story house plan. A covered wrapping porch leads guest inside to the home's entry area. The great room is brightened by 3 windows and warmed by a fireplace. Adjacent to the great room, the kitchen, with a practical breakfast island, walk-up pantry and views to the front yard, opens to the dining area. Upstairs, the master suite's bedroom, which is brightened by 3 windows offers it's own bath room and walk in closet. Bedrooms 2 and 3 each have their own walk-up closets and share a centrally located bath. This home plan is designed with 9' walls, 2x4 construction, rafter framing, and with a basement foundation. Check out our other small house plans! As always any Advanced House Plans home plan can be customized to fit your needs with our alteration department. Whether you need to add another garage stall, change the front elevation, stretch the home larger or just make the home plan more affordable for your budget we can do that and more for you at Ahp.