

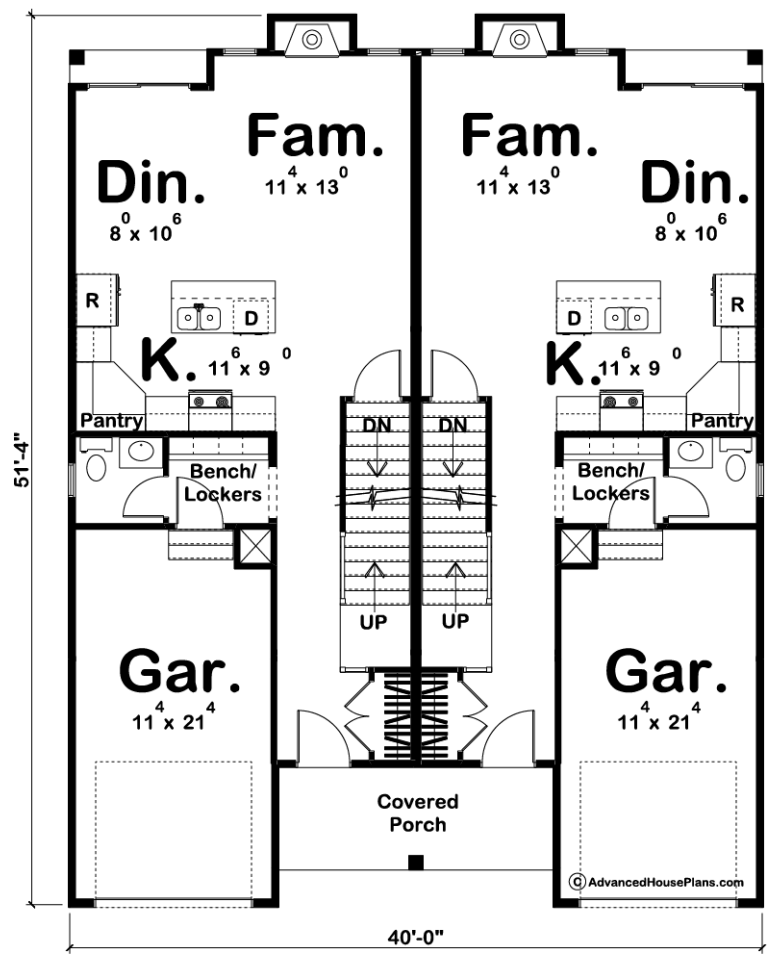

29436 - Degan Park Data Sheet

1489 SQ FT	3 BEDS	3 BATHS	1 BAYS	40' 0" WIDE	52' 0" DEEP
---------------	-----------	------------	-----------	----------------	----------------

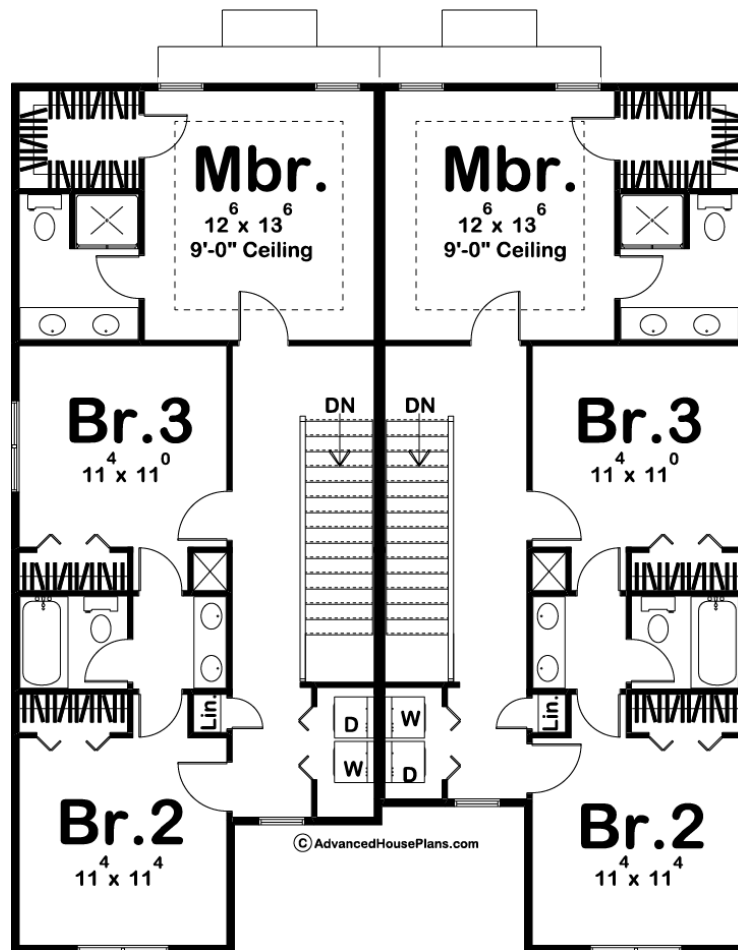



Construction Specs

Layout

Bedrooms	3
Bathrooms	3
Garage Bays	1

Square Footage

Main Level	657 Sq. Ft.
Second Level	832 Sq. Ft.
Garage	260 Sq. Ft.
Total Finished Area	1489 Sq. Ft.

Exterior Dimensions

Width	40' 0"
Depth	52' 0"
Ridge Height	31'
<i>Calculated from main floor line</i>	

Default Construction Stats
Stats are unique to the individual plan.

Foundation Type	Basement
Exterior Wall Construction	2x4
Roof Pitches	8/12 Primary, 6/12 & 4/12 Secondary
Foundation Wall Height	9'
Main Wall Height	9'
Second Wall Height	8'

Plan Description

Craftsman styling provides an air of charming sophistication to this 2-story, narrow multi-family house plan. Inside, guests are greeted by an entry area that opens to a straight staircase. A few steps further reveal the kitchen with its island work area, walk-in pantry, and ample counter space. The adjacent breakfast area provides access to the outside through sliding doors. Open to the kitchen and breakfast area is the great room, with its fireplace and views to the rear. The mud room includes a bench, lockers, coat closet, and powder bath, and also accesses the 1-car garage. Upstairs, a pampering master suite features a bath area with his and her vanities, and an extensive walk-in closet. Bedrooms 2 and 3 share a jack and jill bath. As always any Advanced House Plans home plan can be customized to fit your needs with our alteration department. Whether you need to add another garage stall, change the front elevation, stretch the home larger or just make the home plan more affordable for your budget we can do that and more for you at Ahp. Unless you purchase an unlimited use license or a multi-use license you may only build one home from a set of plans. Plans cannot be re-sold.